

Rok Hotel Kingston
Coffee Shop
Kingston, Jamaica

TAPESTRY
COLLECTION
BY HILTON™



INTERNATIONAL INC.

2055 W 73rd Street, Miami, FL 33016
Ph: (305)826-8696 Fax: (305)826-9131

1	Preliminary Layout	7-31-20
2	Changed style of 221, added 238 to be located by ID.	3-15-21
3	Added MEP Information	4-11-21
4		
No.	Revision/Issue	Date

Date
April 11, 2021
Drawn By
Dayne Gauntlett
Scale
3/8" = 1'0"

Sheet
CS-1.0

EQUIPMENT SCHEDULE					
ItemNo	Category	Mfr	Model	Quantity	Equipment Remarks
221	Display Case, Refrigerated/Non-Refrig	Structural Concepts	NR6051RRSSV	1	
222	POS System	POS	POS	2	By Owner/Operator
223	Espresso Cappuccino Machine	Rancilio/Egro	EGRO ONE-TOP MILK XP	1	By Vendor
224	Disposable Cup Dispenser	Dispense-Rite	ADJ-2F	2	
225	Undermount Sink	Advance Tabco	1014A-10A	1	
225.1	Deck Mount Faucet	Krowne	15-402L	1	
226	Millwork shield	Millwork	SHIELD	1	
227	Spare Number				
228	Rapid Cook Oven	TurboChef	SOTA	1	
229	Coffee Brewer	FETCO	CBS-1152-V+	1	By Vendor
230	Sandwich / Panini Grill	Star	PGT14	1	
231	Blender, Bar	Vitamix	036019-ABAB	1	
233	Undermount Sink	Advance Tabco	CO-1416A-10RE	2	
233.1	Deck Mount Faucet	Krowne	15-402L	2	
234	Undercounter Refrigerator	Continental Refrigerator	D72N-U	2	
235	Paper Napkin Dispenser	Atlas Metal	N-1	1	
236	Flatware Holder, Utensil Holder Display Caddy	Cal-Mil	3811-83	1	By Owner/Operator
237	Condiment Caddy	Cal-Mil	3801-83	1	By Owner/Operator
238	Refrigerated Merchandiser	True Mfg. - General Foodservice	GDM-19T-HC-TSL01	1	
239	Ice Maker with Bin, Cube-Style	Ice-O-Matic	ICEU220HA	1	

EQUIPMENT
LAYOUT

All Dimensions to be verified on the job site.
Actual locations for floor drains, and any ventilating
equipment to be determined by Engineer.
Mechanical, Plumbing & Electrical to be checked and verified
by Customers MEP Engineer.
Remote Condensing Units to be located by Architect.
Exhaust & Supply fans to be located by Architect.

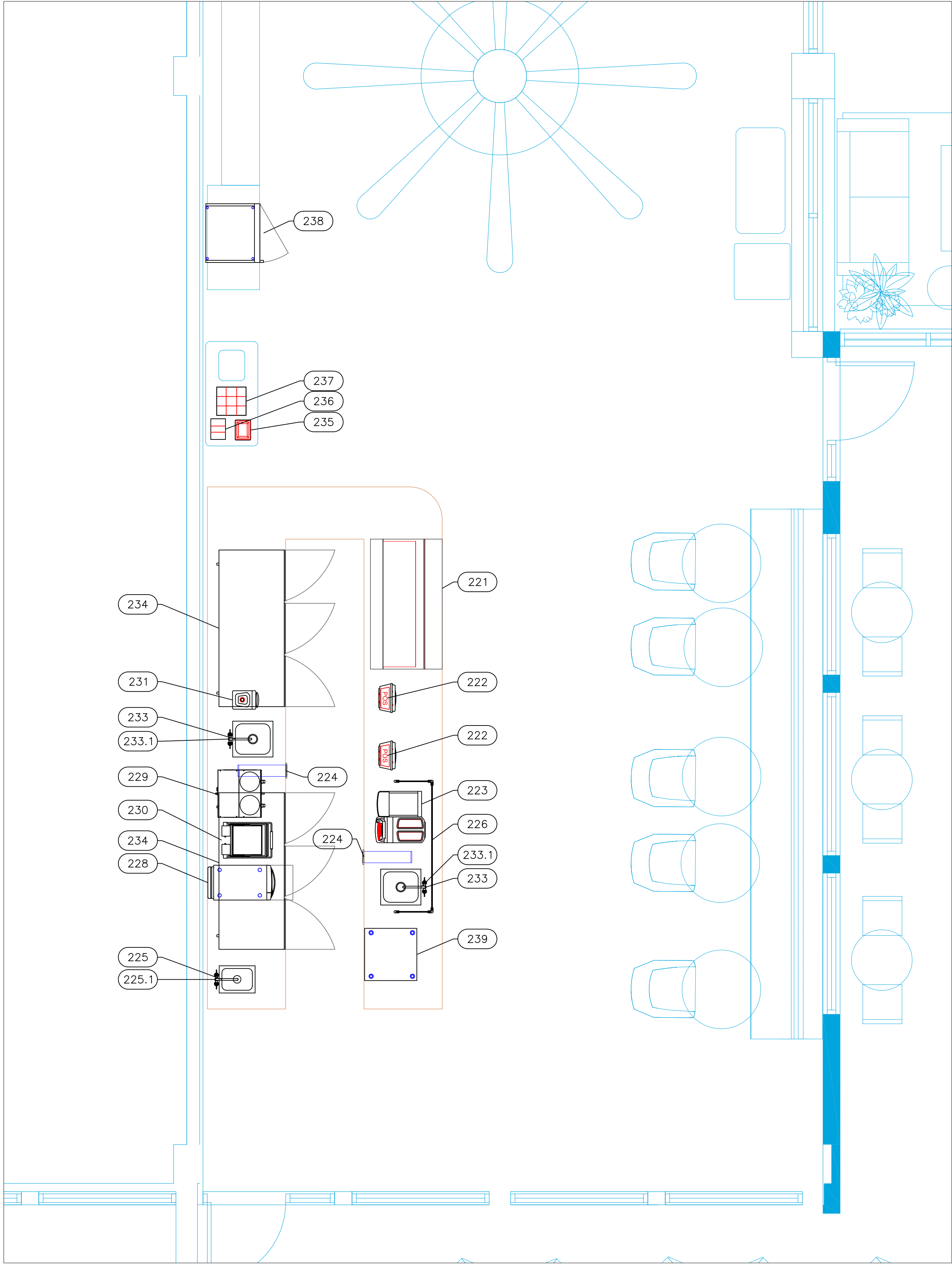

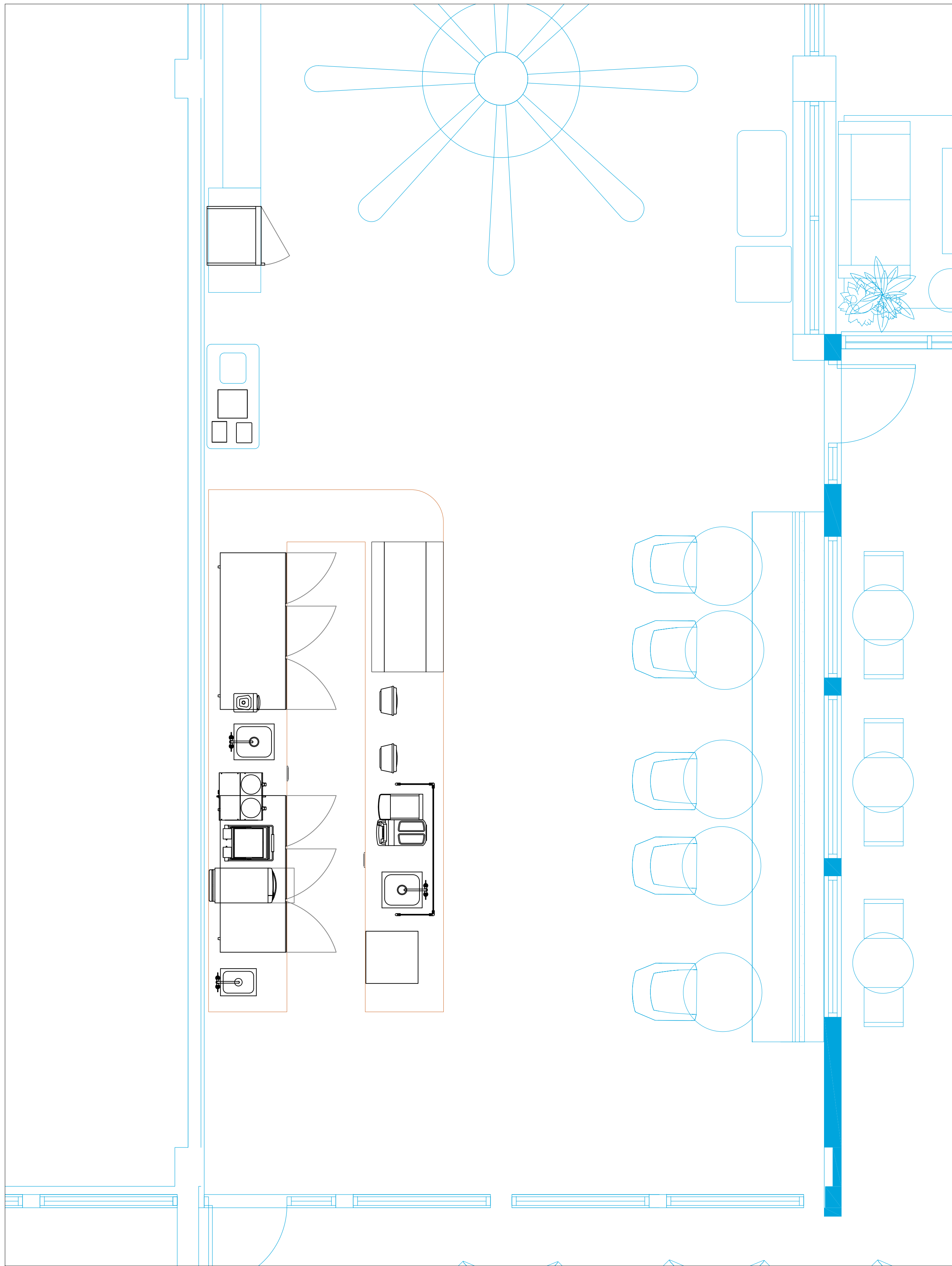

Mechanical Schedule						
ITEM NO.	QTY	DISCRIPTION	EXHAUST (L X W)	EXHAUST (CFM)	Makeup Vent Width	SUPPLY (CFM)
			Ventilation Remarks			

LEGEND – MECHANICAL

- EXHAUST DUCT COLLAR
- SUPPLY DUCT COLLAR
- INWALL BACKING FOR WALL SHELVES
- RECESSED FLOOR
- RAISED EQUIPMENT PAD

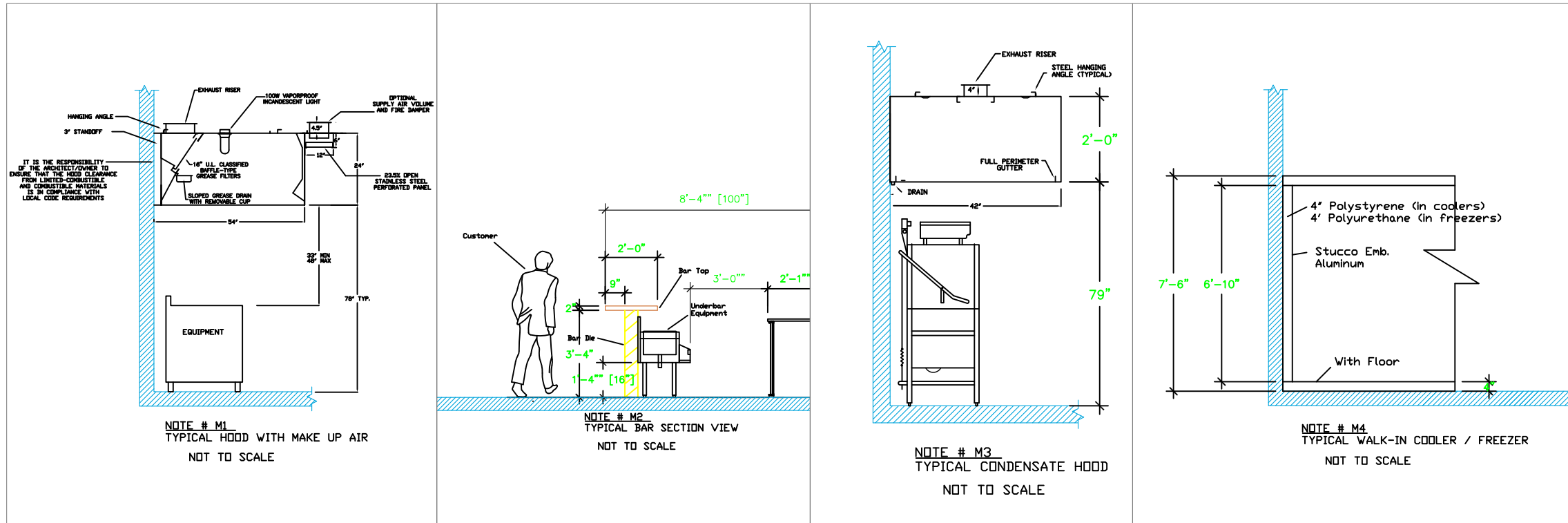

NOTE # M5
ALL NATIONAL, STATE, AND LOCAL
CODES SHALL APPLY.

NOTE # M6
ARCHITECT OR ENGINEER TO SIZE
AND LOCATE, CONTRACTOR TO
PROVIDE ALL OPENINGS FOR
DUCTS, PLUMBING LINES,
ELECTRICAL LINES, AND
REFRIGERATION LINES, AS
REQUIRED BY EQUIPMENT.

NOTE # M7
SUPPLY FANS TO BE LOCATED A
MINIMUM OF 10' FROM EXHAUST
FANS.

NOTE # M8
SHOP DRAWING WILL BE
PROVIDED BY MANUFACTURER FOR
HOOD, EXHAUST FANS, & SUPPLY
FANS, ONCE ORDER IS PLACE
WITH.

NOTE # M9
GENERAL CONTRACTOR TO
PROVIDE 2" PLYWOOD WALL
BACKING FROM 48" TO 78" AFF
FOR ALL WALL MOUNTED
EQUIPMENT.

NOTE # M10
CEILING HEIGHTS TO BE
VERIFIED FOR SUFFICIENT
CLEARANCE FOR EQUIPMENT.

NOTE # M11
REFRIGERATION CONTRACTOR TO
HANG EVAPORATORS FOR
WALK-IN, RUN & CHARGE LINES
BETWEEN EVAP. & CONDENSING
UNIT.

Equipment
MECHANICAL
Service Requirements

All Dimensions to be verified on the job site.
Actual locations for floor drains, and any ventilating
equipment to be determined by Engineer.
Mechanical, Plumbing & Electrical to be checked and verified
by Customers MEP Engineer.
Remote Condensing Units to be located by Architect.
Exhaust & Supply Fans to be located by Architect.

Rok Hotel Kingston
Coffee Shop
Kingston, Jamaica

TAPESTRY
COLLECTION
BY HILTON™

uni-source
SUPPLY

INTERNATIONAL INC.

2055 W 73rd Street, Miami, FL 33016
Ph:(305)826-8696 Fax:(305)826-9131

1	Preliminary Layout	7-31-20
2	Changed style of 221, added 238 to be located by ID.	3-15-21
3	Added MEP Information	4-11-21
4		
No.	Revision/Issue	Date

Date
April 11, 2021
Drawn By
Dayne Gauntlett
Scale
3/8" = 1'0"

Sheet
CS-2.0

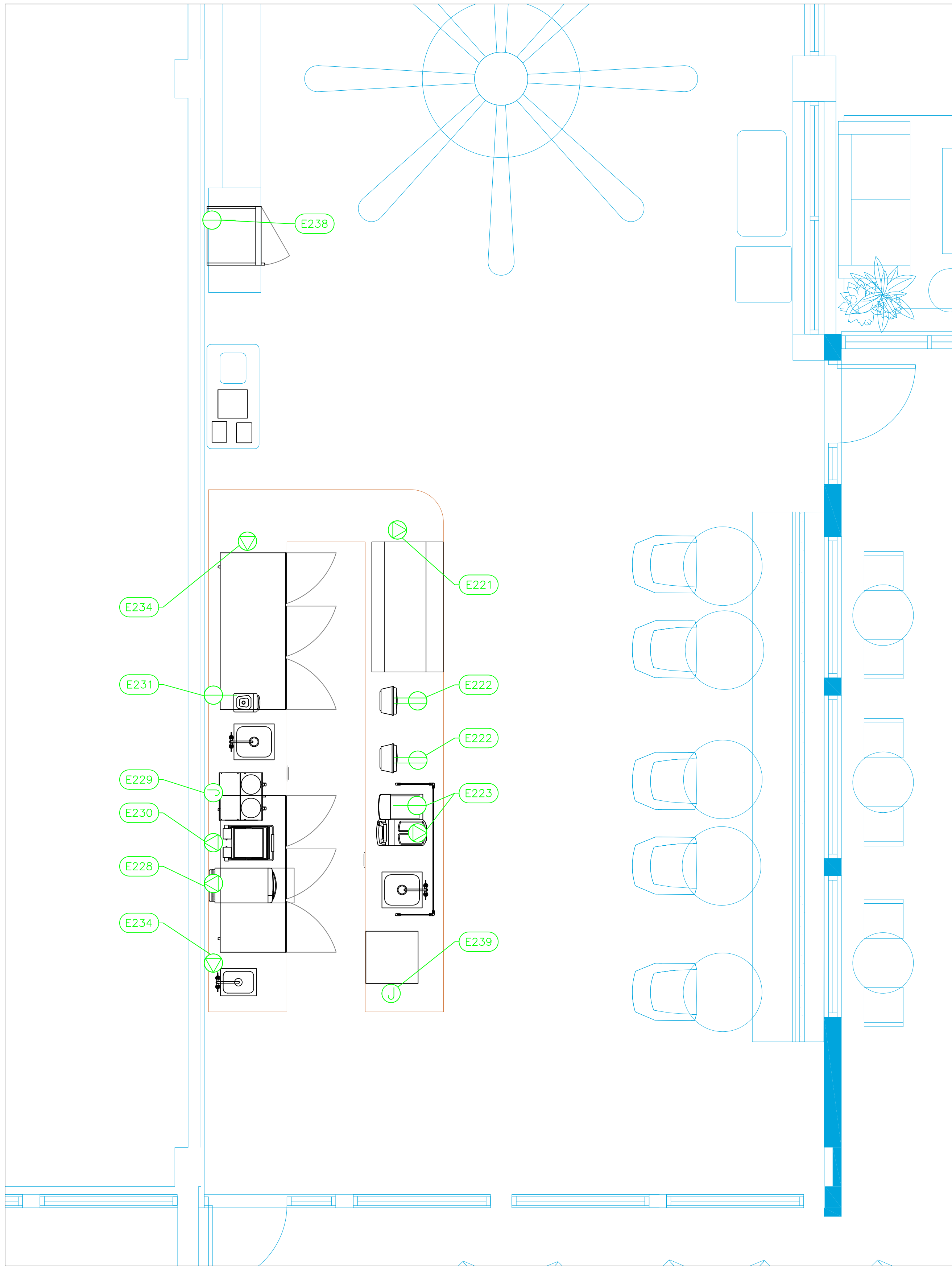

ELECTRICAL SCHEDULE											
ItemNo	Category	Voltage	Cycle	Phase	Amps	Hp	NEMA	ConnectionType	Rough-In AFF	Quantity	Electrical Remarks
221	Display Case, Refrigerated/Non-Refrig	208-240	50	1	11.26			Special	Floor	1	
222	POS System	115	50	1	15			Duplex	48"	2	Confirm Requirements with Owner
223	Espresso Cappuccino Machine	220	50	1	30			Special	Floor	1	Confirm Requirements with Owner
		110	50	1	15			Simplex	Floor	1	
228	Rapid Cook Oven		50					Special	48"	1	
229	Coffee Brewer	208-240	50	1	25.8			J-Box	48"	1	Confirm Requirements with Owner
230	Sandwich / Panini Grill	208/240	50/60	1	6.5/7.5		6-15P	Special	48"	1	
231	Blender, Bar	120	50/60	1	15		5-15P	Simplex	48"	1	
234	Undercounter Refrigerator	220	50	1	1.85	1/5		Special	18"	2	
238	Refrigerated Merchandiser	230-240	50	1	2.4	1/3	5-15P	Simplex	18"	1	
239	Ice Maker with Bin, Cube-Style	230	50	1	4.9			J-Box	18"	1	

LEGEND - ELECTRICAL CONNECTIONS

- DUPLEX RECEPT., 15-AMP, 120-VOLT, GROUND TYPE, HORIZONTAL MOUNT
- SIMPLEX RECEPT., 120-VOLT, GROUND TYPE, HORIZONTAL MOUNT
- SPECIAL PURPOSE OUTLET, GROUND TYPE, HORIZONTAL MOUNT
- JUNCTION BOX, DIRECT CONNECTION
- DISCONNECT SWITCH, DIRECT CONNECTION
- FLOOR/CEILING RECEPTACLE AS INDICATED
- (2) Telephone + (2) Data
- FIELD CONNECTIONS
- HARD WIRE CONNECTION POINT AT MACHINE

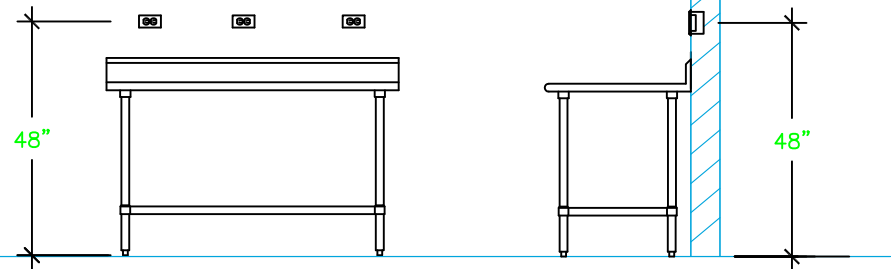

NOTE # E1
TYPICAL OUTLETS IN WALL
ABOVE TABLE, BY ELECTRICIAN
NOT TO SCALE

NOTE # E2
ALL NATIONAL, STATE, AND LOCAL
CODES SHALL APPLY

NOTE # E3
ALL ELECTRICAL CONNECTIONS
AND HARDWARE REQUIRED TO BE
PROVIDED BY ELECTRICAL
CONTRACTOR

NOTE # E4
ALL JUNCTION BOXES, OUTLETS,
ETC. TO BE LOCATED SO AS TO
NOT INTERFERE WITH EQUIPMENT

NOTE # E5
ALL RELAYS, CONTRACTORS,
STARTERS, AND SWITCHES
REQUIRED FOR EXHAUST & SUPPLY
FANS TO BE PROVIDED BY
ELECTRICAL CONTRACTOR
UNLESS SPECIFIED

NOTE # E6
ELECTRICAL CONTRACTOR TO
INTERCONNECT DISHWASHER TO
EXHAUST FAN FOR DISHWASHER
SO THAT THE FAN RUNS WHEN
THE DISHWASHER IS IN
OPERATION.

NOTE # E7
ELECTRICAL CONTRACTOR TO
INSTALL TABLE LIMIT SWITCH TO
END OF CLEAN DISHABLE TO
THAT MACHINE STOPS WHEN
SWITCH IS DEPRESSED.

NOTE # E8
ELECTRICAL CONTRACTOR TO
CONNECT DRAIN LINE HEATER,
PAN HEATER AND DOOR HEATER
FOR WALK-IN FREEZER.

Equipment ELECTRICAL Service Requirements

All Dimensions to be verified on the job site.
Actual locations for floor drains, and any ventilating
equipment to be determined by Engineer.
Mechanical, Plumbing & Electrical to be checked and verified
by Customers MEP Engineer.
Remote Condensing Units to be located by Architect.
Exhaust & Supply fans to be located by Architect.

Rok Hotel Kingston
Coffee Shop
Kingston, Jamaica

TAPESTRY
COLLECTION
BY HILTON™

uni-source
SUPPLY
INTERNATIONAL INC.

2055 W 73rd Street, Miami, FL 33016
Ph:(305)826-8696 Fax:(305)826-9131

1	Preliminary Layout	7-31-20
2	Changed style of 221, added 238 to be located by ID.	3-15-21
3	Added MEP Information	4-11-21
4		
No.	Revision/Issue	Date

Date
April 11, 2021
Drawn By
Dayne Gauntlett
Scale
3/8" = 1'0"

Sheet
CS-3.0

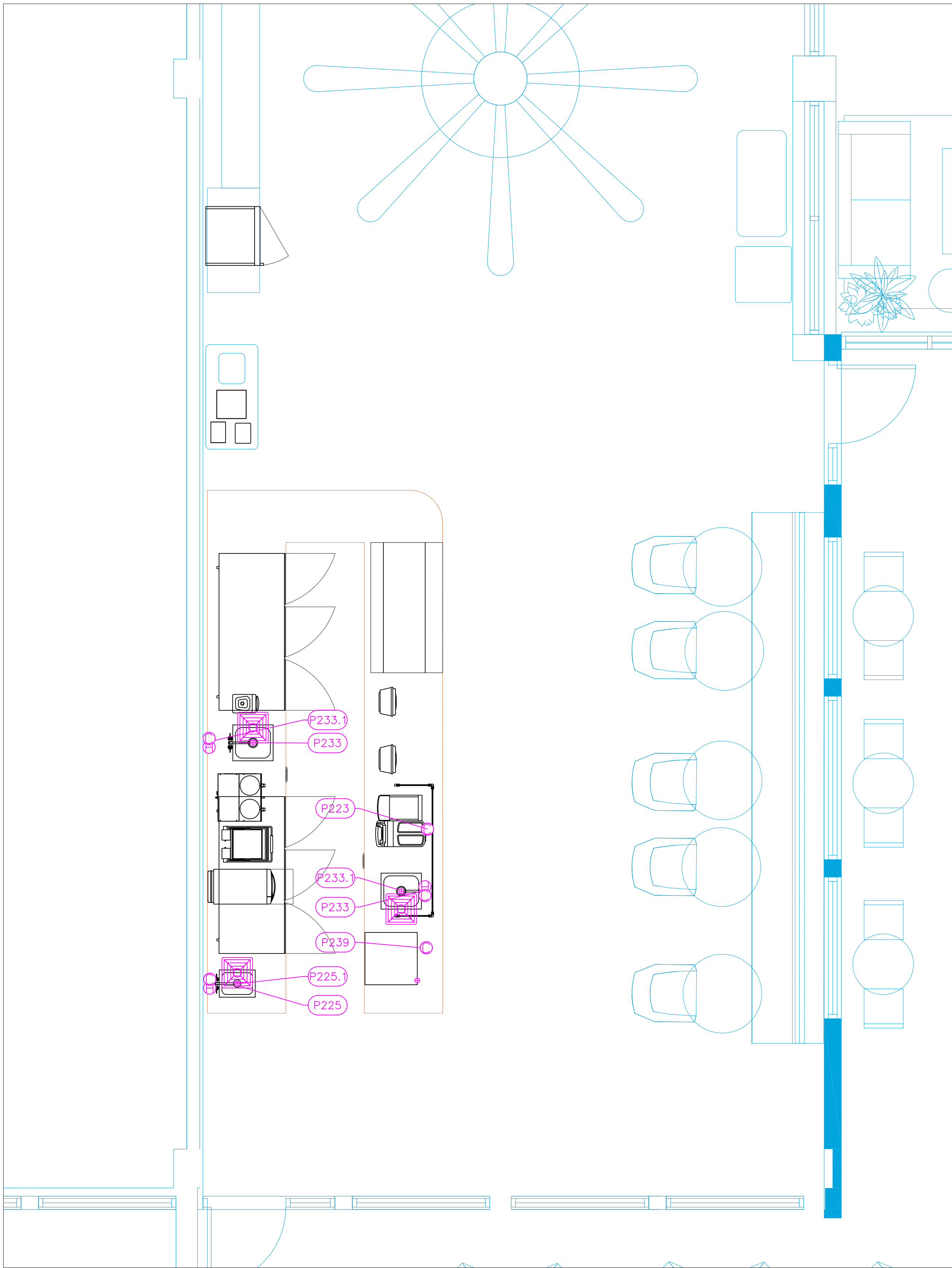

PLUMBING SCHEDULE												
ITEM NO.	DESCRIPTION	COLD WATER SIZE	HOT WATER SIZE	H&C Rough-In	DIRECT WASTE SIZE	DIRECT WASTE AFF	INDIRECT WASTE SIZE	GAS SIZE (IN)	GAS MBTU	QTY	PLUMBING REMARKS	
223	Espresso Cappuccino Machine	3/8"		12"			2"			1	Waste to Floor Sink	
225	Undermount Sink						1-1/2"			1	Waste to Floor Sink	
225.1	Deck Mount Faucet	1/2"	1/2"	12"						1		
229	Coffee Brewer	3/8"		12"						1		
233	Undermount Sink						1-1/2"			2	Waste to Floor Sink	
233.1	Deck Mount Faucet	1/2"	1/2"	12"						2		
239	Ice Maker with Bin, Cube-Style	3/8"		12"			3/4"			1	Waste to Floor Sink	

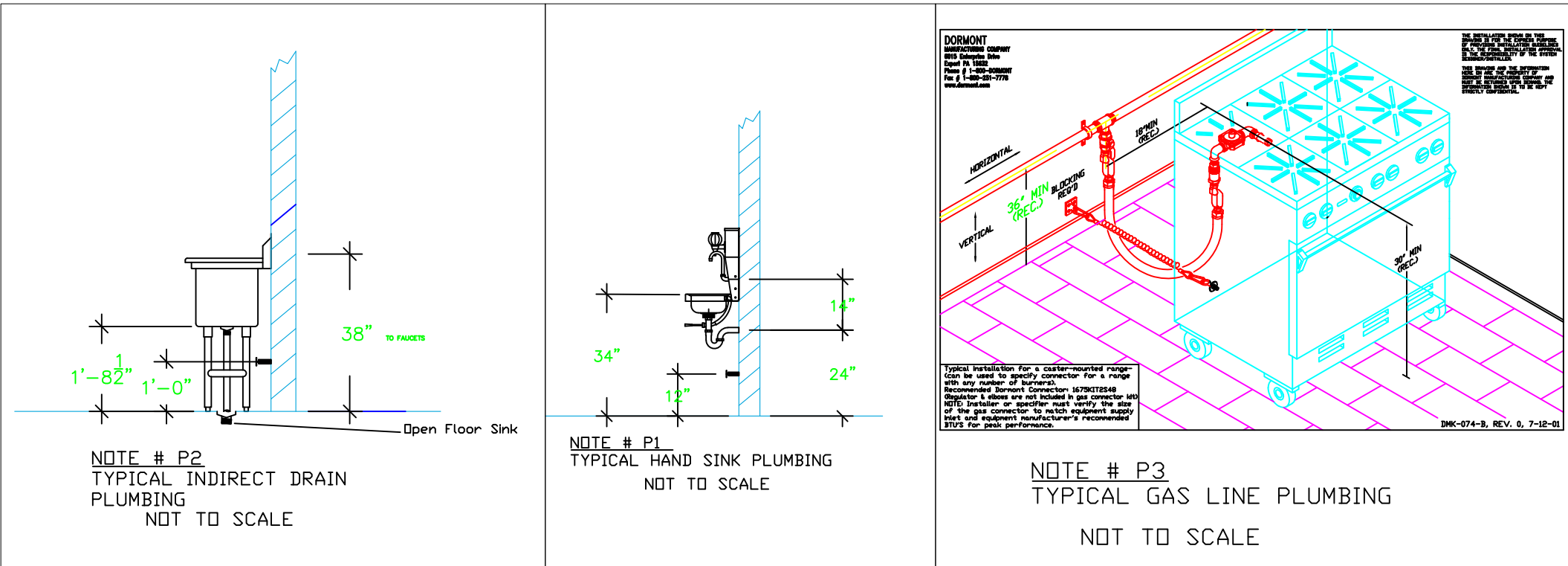

LEGEND – PLUMBING CONNECTIONS

- HW-HOT WATER, OR CW-COLD WATER
- GAS
- WASTE, DIRECT-CONNECTED
- WASTE, INDIRECT to Floor Sink
- WASTE, INDIRECT to Funnel Floor Drain
- FLOOR DRAIN
- WASTE, INDIRECT to Floor Sink

NOTE # P4: ALL NATIONAL, STATE, AND LOCAL CODES SHALL APPLY

NOTE # P5: ALL PLUMBING CONNECTIONS TO BE EXTENDED AND INTERCONNECTED TO EQUIPMENT AND ALL HARDWARE REQUIRED TO BE PROVIDED BY PLUMBING CONTRACTOR

NOTE # P6: PLUMBING CONTRACTOR TO VERIFY THAT ALL EQUIPMENT IS INSTALLED WITH THE APPROPRIATE GAS PRESSURE AND REGULATORS

NOTE # P7: ALL WASTE LINES AND CONDENSATE LINES TO BE EXTEND FROM EQUIPMENT TO FLOOR DRAINS BY PLUMBING CONTRACTOR.

Equipment PLUMBING Service Requirements

All Dimensions to be verified on the job site. Actual locations for floor drains, and any ventilating equipment to be determined by Engineer. Mechanical, Plumbing & Electrical to be checked and verified by Customers MEP Engineer. Remote Condensing Units to be located by Architect. Exhaust & Supply fans to be located by Architect.

Rok Hotel Kingston
Coffee Shop
Kingston, Jamaica

TAPESTRY
COLLECTION
BY HILTON™

uni-source
SUPPLY

INTERNATIONAL INC.

2055 W 73rd Street, Miami, FL 33016
Ph:(305)826-8696 Fax:(305)826-9131

1	Preliminary Layout	7-31-20
2	Changed style of 221, added 238 to be located by ID.	3-15-21
3	Added MEP Information	4-11-21
4		
No.	Revision/Issue	Date

Date
April 11, 2021
Drawn By
Dayne Gauntlett
Scale
3/8" = 1'0"

Sheet
CS-4.0