

Baha Mar  
Jazz Bar  
Nassau, Bahamas



INTERNATIONAL INC.

2055 W 73rd Street, Miami, FL 33016  
Ph: (305)826-8696 Fax: (305)826-9131

| No. | Revision/Issue                                   | Date    |
|-----|--|---------|
| 2   | Updated Layout after new background              | 7-10-23 |
| 3   | Added Main Bar Support, updated kitchen.         | 7-31-23 |
| 4   | Removed equipment from behind main bar.          | 8-30-23 |
| 5   | Operations comments, hot line changes, soda guns | 8-30-23 |

Date

Aug 30, 2023b

Drawn By

Dayne Gauntlett

Scale

1/8" = 1'0"

Sheet

**FS-1.0**

## EQUIPMENT OVERVIEW

All Dimensions to be verified on the job site.  
Actual locations for floor drains, and any ventilating equipment to be determined by Engineer.  
Mechanical, Plumbing & Electrical to be checked and verified by Customers MEP Engineer.  
Remote Condensing Units to be located by Architect.  
Exhaust & Supply fans to be located by Architect.

| ItemNo | Category                                  | Mfr                      | Model                   | Quantity | Equipment Remarks |
|--------|---|--------------------------|-------------------------|----------|-------------------|
| 1      | Rapid Cook Oven                           | TurboChef                | PLE-9500-2-DL-RRR       | 1        |                   |
| 2      | Ventless Fryer                            | WVIAE                    | 55FC                    | 1        |                   |
| 3      | Reach-In Heated Cabinet                   | Continental Refrigerator | DL1W                    | 1        |                   |
| 4      | Induction Range, Countertop               | CookTek                  | 601701                  | 1        |                   |
| 5      | Chef's Table                              | Custom Fab               | Q1711-5                 | 1        |                   |
| 5.1    | Heat Lamp                                 | Hatco                    | GRAHL-42                | 2        |                   |
| 5.3    | Undercounter Refrigerator                 | Continental Refrigerator | SW60N-U-D               | 1        |                   |
| 5.4    | Deck Mount Faucet                         | Krowne                   | 15-410                  | 1        |                   |
| 7      | Hot Food Holding Cabinet                  | Alto-Shaam               | 750-CTUS                | 1        |                   |
| 8      | Sandwich / Salad Preparation Refrigerator | Continental Refrigerator | SW48N10-D               | 1        |                   |
| 8.1    | Shelving, Wall Mounted                    | Advance Tabco            | WS-15-48-16             | 1        |                   |
| 8.2    | Shelving, Wall Mounted                    | Advance Tabco            | WS-15-84-16             | 1        |                   |
| 9      | Walk In Cooler, Modular, Self-Contained   | Arctic Industries        | BL68-CF-5C              | 1        |                   |
| 9.3    | Shelving Unit, Wire                       | Quantum                  | WR63-1436GY             | 1        |                   |
|        | Shelving Unit, Wire                       | Quantum                  | WR63-1854GY             | 1        |                   |
| 10     | Dishwasher, Door Type, Ventless           | Jackson WWS              | TEMPSTAR VENTLESS (VER) | 1        |                   |
| 11     | Soiled Dishtable                          | Advance Tabco            | DTS-S30-72R             | 1        |                   |
| 11.1   | Pre-Rinse Faucet Assembly                 | Krowne                   | 17-108W/L               | 1        |                   |
| 11.2   | Soak Sink                                 | Advance Tabco            | B-FSC-20                | 1        |                   |
| 12     | Clean Dishtable                           | Advance Tabco            | DTC-S30-48L             | 1        |                   |
| 12.1   | Dishtable Sorting Shelf                   | Advance Tabco            | DT-6R-22                | 2        |                   |
| 13     | Shelving Unit, Wire                       | Quantum                  | WR63-1860GY             | 2        |                   |
| 14     | Shelving Unit, Wire                       | Quantum                  | WR63-1980GY             | 2        |                   |
| 15     | Soda Bag Aml Box                          | Vendor                   | SODA BAG AND BOX        | 1        | By Vendor         |
| 31     | Corner Angle Filler                       | Glastender               | ICCB-15                 | 2        |                   |
| 32     | Back Bar Cabinet, Refrigerated            | Glastender               | C1FB60                  | 1        |                   |
| 33     | Bottle Cooler                             | Glastender               | ST24-S                  | 1        |                   |
| 34     | Ice Bin                                   | Glastender               | IBA-24-CP10             | 1        |                   |
| 34.1   | Overshell                                 | Advance Tabco            | CM-18-48                | 1        |                   |
| 35     | Underbar Mikology Sink Unit               | Glastender               | MTS-14                  | 1        |                   |
| 35.1   | Soda Gun Holder & Tubing Chase            | Glastender               | SHB-6                   | 1        |                   |
| 36     | Bottle Storage Unit                       | Glastender               | LDA-12S                 | 1        |                   |
| 37     | Ice Maker, Cube-Style                     | Hoshizaki                | IM-500SAB               | 2        |                   |
| 38     | Ice Bin for Ice Machines                  | Hoshizaki                | B-700SF                 | 1        |                   |
| 38     | Ice Maker with Bin, Cube-Style            | Hoshizaki                | IM-50BAA-LM             | 1        |                   |
| 51     | Dishwasher, Door Type, Ventless           | Jackson WWS              | TEMPSTAR VENTLESS (VER) | 1        |                   |
| 52     | Soiled Dishtable                          | Advance Tabco            | DTS-S30-72L             | 1        |                   |
| 52.1   | Pre-Rinse Faucet Assembly                 | Krowne                   | 17-108W/L               | 1        |                   |
| 52.2   | Soak Sink                                 | Advance Tabco            | B-FSC-20                | 1        |                   |
| 52.3   | Dishtable Sorting Shelf                   | Advance Tabco            | DT-6R-22                | 2        |                   |
| 53     | Clean Dishtable                           | Advance Tabco            | DTC-S30-48R             | 1        |                   |
| 54     | Foodservice Door                          | Chase Doors              | SCP3 36X84              | 1        |                   |
| 55     | Shelving Unit, Wire                       | Quantum                  | WR63-1842GY             | 1        |                   |
| 56     | Ice Maker, Cube-Style                     | Hoshizaki                | IM-500SAB               | 2        |                   |
| 56     | Ice Bin for Ice Machines                  | Hoshizaki                | B-700SF                 | 1        |                   |
| 57     | Ice Maker with Bin, Cube-Style            | Hoshizaki                | IM-50BAA-LM             | 1        |                   |
| 61     | Back Bar Cabinet, Refrigerated            | Glastender               | C1SB48                  | 1        |                   |
| 62     | Reach-In Display Refrigerator, 2 sections | Continental Refrigerator | D2RSNGDHD               | 1        |                   |
| 63     | Ice Bin                                   | Glastender               | IBA-24-CP10             | 2        |                   |
| 64     | Underbar Mikology Sink Unit               | Glastender               | MTS-14                  | 2        |                   |
| 64.1   | Soda Gun Holder & Tubing Chase            | Glastender               | SHB-6                   | 2        |                   |
| 65     | Bottle Storage Unit                       | Glastender               | LDA-18S                 | 2        |                   |
| 66     | Bottle Cooler                             | Glastender               | ST24-S                  | 2        |                   |
| 67     | Shelving, Wall Mounted                    | Advance Tabco            | WS-15-48                | 2        |                   |
| 75     | Ice Bin                                   | Glastender               | IBA-24-CP10             | 4        |                   |
| 76     | Corner Angle Filler                       | Glastender               | ICCB-15                 | 8        |                   |
| 76.1   | Corner Angle Filler                       | Glastender               | ICCB-20                 | 4        |                   |
| 77     | Bottle Storage Unit                       | Glastender               | LDA-12S                 | 5        |                   |
| 78     | Underbar Mikology Sink Unit               | Glastender               | MTS-14                  | 4        |                   |
| 78.1   | Soda Gun Holder & Tubing Chase            | Glastender               | SHB-6                   | 4        |                   |
| 79     | Underbar Add-On Unit                      | Glastender               | DWB-12                  | 3        |                   |
| 79.1   | Underbar Add-On Unit                      | Glastender               | DWB-16R                 | 2        |                   |
| 80     | Hand Sink                                 | Glastender               | DHSB-12                 | 1        |                   |
| 81     | Drainboard                                | Glastender               | DBC-12                  | 1        |                   |
| 82     | Underbar Ice Station                      | Custom Fab               | Q1711-82                | 1        |                   |
| 83     | Glass Froster                             | Glastender               | F1SL24                  | 1        |                   |
| 84     | Back Bar Cabinet, Refrigerated            | Glastender               | C1SB48                  | 4        |                   |
| 101    | Shelving Unit, Wire                       | Quantum                  | WR63-2460GY             | 2        |                   |

Main Bar

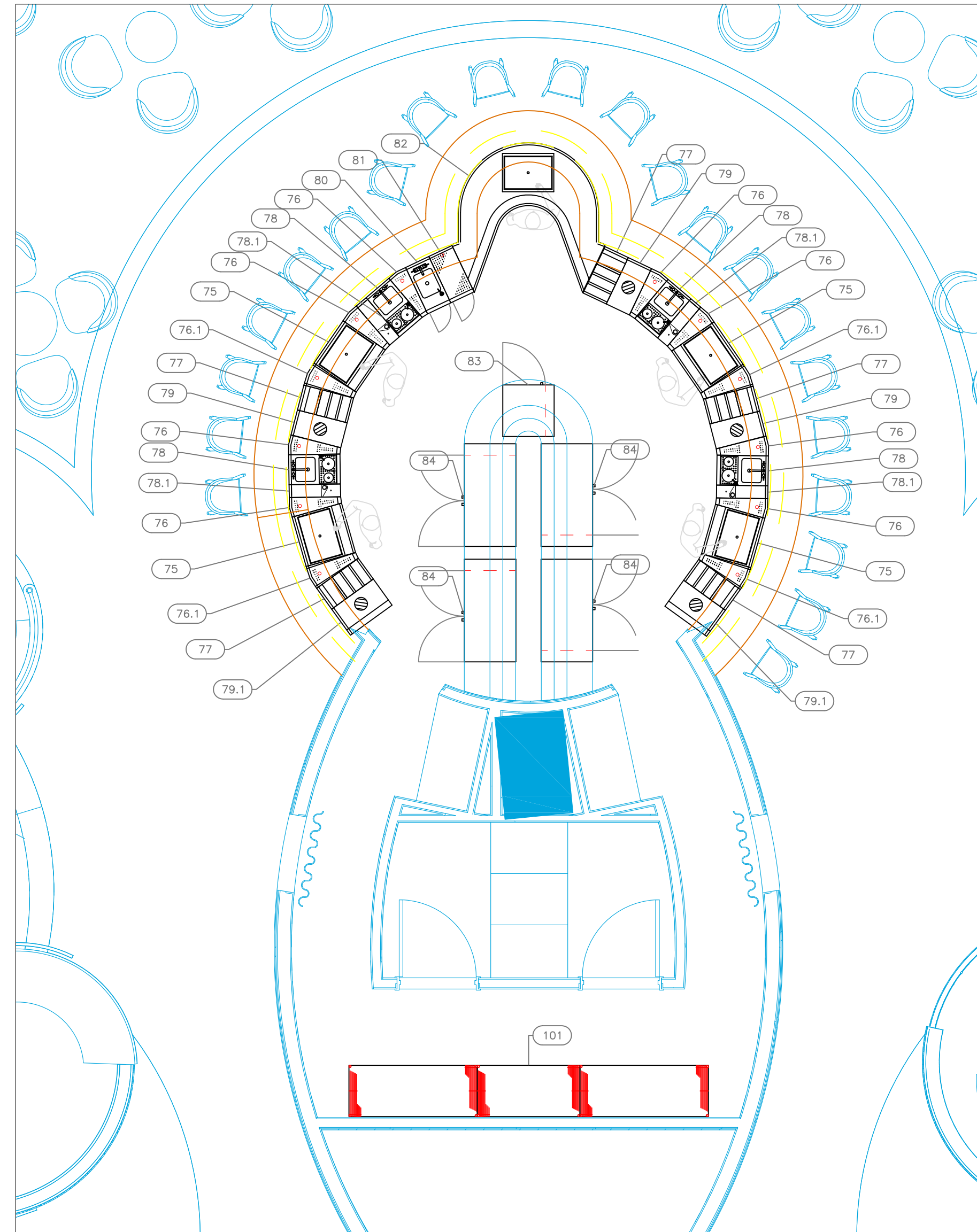

Main Bar Support

Service Kitchen/Bar 2

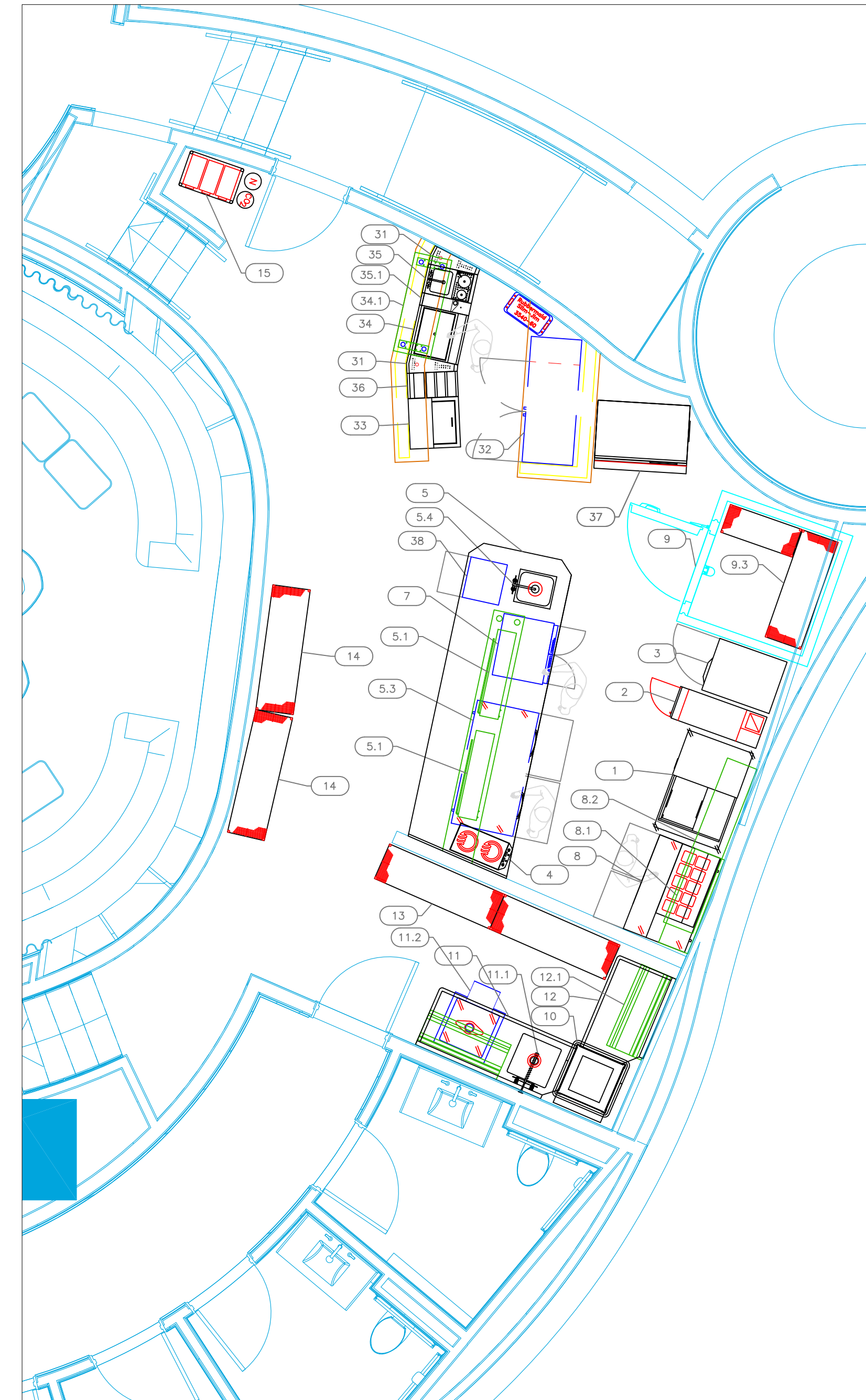

Service Bar 1

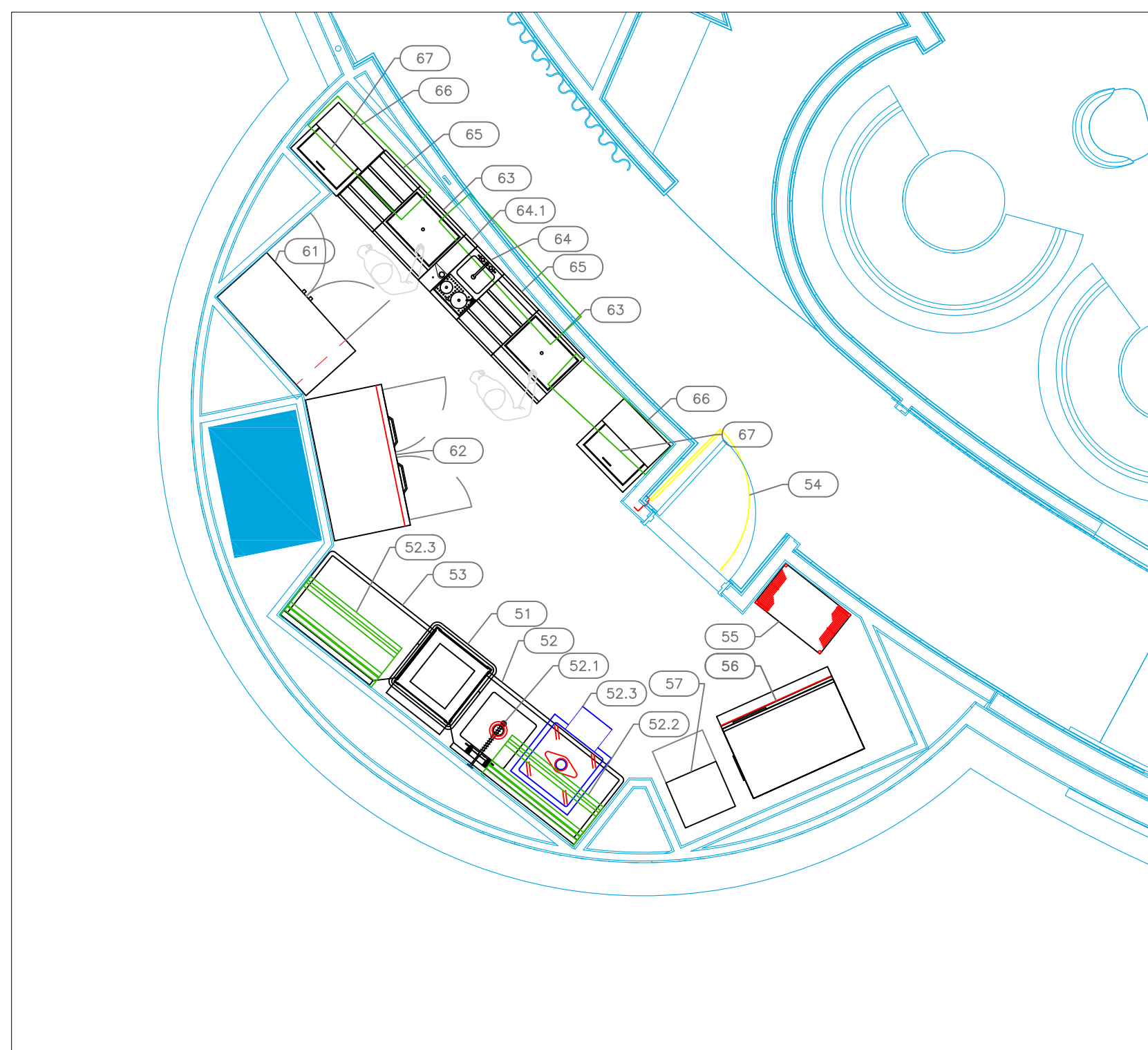

# EQUIPMENT OVERVIEW

All Dimensions to be verified on the job site.  
 Actual locations for floor drains, and any ventilating equipment to be determined by Engineer.  
 Mechanical, Plumbing & Electrical to be checked and verified by Customers MEP Engineer.  
 Remote Condensing Units to be located by Architect.  
 Exhaust & Supply fans to be located by Architect.

**Baha Mar  
 Jazz Bar  
 Nassau, Bahamas**



INTERNATIONAL INC.

2055 W 73rd Street, Miami, FL 33016  
 Ph: (305)826-8696 Fax: (305)826-9131

| 2   | Updated Layout after new background              | 7-10-23 |
|-----|--|---------|
| 3   | Added Main Bar Support, updated kitchen.         | 7-31-23 |
| 4   | Removed equipment from behind main bar.          | 8-30-23 |
| 5   | Operations comments, hot line changes, soda guns | 8-30-23 |
| No. | Revision/Issue                                   | Date    |

Date  
**Aug 30, 2023b**  
 Drawn By  
**Dayne Gauntlett**  
 Scale  
**1/4" = 1'0"**

Sheet  
**FS-1.1**