

Club House Main Kitchen

EQUIPMENT SCHEDULE						
ItemNo	Category	Mfr	Model	Quantity	Equipment Remarks	
3	Heated Banquet Cart	Alto-Shaam	1000-BQ2/192	1		
7	Gas Fryer, Battery	Vulcan	2GR45MF	1		
9	Tilting Skillet Braising Pan, Gas	Cleveland	SGL40T1NATHTPQS	1		
10	Tilting Skillet Braising Pan, Gas	Cleveland	SGL40T1NATHTPQS	1		
11	Tilting Skillet Braising Pan, Gas	Cleveland	SGL40T1NATHTPQS	1		
101	Convection Oven, Gas	Southbend (Middleby)	PCG100S/SD	1		
102	Convection Oven, Gas	CPG	351FGC100L	1		
103	Stock Pot Range, 2 Two-Ring Burners	Vulcan	VSP200F	1		
104	Griddle, Gas, Countertop	Globe (Middleby)	GG36TG	1		
105	Charbroiler, Gas, Countertop	Globe (Middleby)	GCB36G-CR	1		
106	Chef Base	True Int'l - LATAM/Caribbean (USD)	TRCB-72-HC	1		
107	Range, 36", 6 Open Burners	Southbend (Middleby)	S36D	1		
107.1	Salamander Broiler, Gas	Southbend (Middleby)	P36-RAD	1		
108	Broiler, Deck-Type, Gas	Garland Commercial Ranges	M100XRM	1		
109	Range, 60", 10 Open Burners	Southbend (Middleby)	S60DD	1		
110	Gas Floor Fryer	Vulcan	1GR45M	1		
111	Work Table, Stainless Steel Top	Advance Tabco	KMS-308	1		
112	Hand Sink	Advance Tabco	7-PS-66	1		
113	Work Table, Stainless Steel Top	Advance Tabco	KMS-308	1		
114	Planetary Mixer	Varimixer (Middleby)	V60	1		
115	Electric Food Cutter	Univex	BC18	1		
116	Shelving Unit, Wire	Quantum	WR74-2472GY	2		
117	Three (3) Compartment Sink	Advance Tabco	FC-3-3024-36RL	1		
117.1	Disposer	Salvajor	300-CA-12-ARSS	1		
117.2	Wall / Splash Mount Faucet	Krowne	14-812L	1		
118	Refrigerated Table with Sink	Custom	TABLE	1		
119	Refrigerated Sandwich Table	Custom	TABLE	1		
120	Dish Cabinet	Advance Tabco	DC-1810	2		
120.1	Deck Mount Faucet	Krowne	15-410L	1		
121	Reach-In Refrigerator	True Int'l - LATAM/Caribbean (USD)	T-49-HC	1		
121.1	Reach-In Refrigerator	True Int'l - LATAM/Caribbean (USD)	T-49-HC	1		
122	Reach-In Display Refrigerator, 1 section	Traulsen	RHT132DUT-FHG	1		
123	Planetary Mixer	Hobart	HL120-1	1		
124	Work Table, Stainless Steel Top	Advance Tabco	KMS-305	1		
124.1	Microwave Oven	ACP	RCS10TS	1		
125	Hand Sink	Advance Tabco	7-PS-66	1		
126	Work Table, Stainless Steel Top	Advance Tabco	KMS-308	1		
126.1	Weld-In Sink	Advance Tabco	TA-11J	1		
126.2	Food Slicer, Electric	Hobart	EDGE13-11	1		
128.2	Deck Mount Faucet	Krowne	15-410L	1		
127	Work Table, Stainless Steel Top	Advance Tabco	KMS-308	1		
128	Two (2) Compartment Sink	Advance Tabco	FC-2-2424-24RL	1		
128.1	Wall / Splash Mount Faucet	Krowne	14-812L	1		
129	Pizza Preparation Refrigerator	Traulsen	TS909HT	1		
130	Work Table, Stainless Steel Top	Advance Tabco	KMS-306	1		
130.1	Trash Receptacle, Mobile	Rubbermaid	FG9W2200GRAY	1		
131	Solled Dishtable	Advance Tabco	DTS-U30-120L	1		
131.1	Pre-Rinse Faucet Assembly	Krowne	17-108WL	1		
132	Dishwasher, Conveyor Type	CMA Dishmachines	EST-44	1		
133	Clean Dishtable	Advance Tabco	DTC-S30-60R	1		
134	Beverage Counter	Advance Tabco	BEV-30-144L	1		
134.1	Warming Drawer, Built-In	Hatco	HDIW-2B	1		
134.2	Oil Filter System, Mobile	Vito Fry/Filter, Inc.	VITO XS	1		
134.1	Wall / Splash Mount Faucet	Krowne	14-408L	1		
135	Chest Freezer	Atosa USA, Inc.	MWF9016GR	1		
136	Reach-In Refrigerator	True Int'l - LATAM/Caribbean (USD)	T-49-HC	1		
138	Shelving Unit, All Plastic	Quantum	QP244874VS-4	1		
141	Walk-In Combo	Arclic Industries	WALK-IN COMBO	1		
141.1	Evaporator for Cooler	Arclic Industries	EVAP C	1		
141.2	Remote Condenser Unit for Cooler	Arclic Industries	COND C	1		
141.3	Evaporator for Cooler	Arclic Industries	EVAP C	1		
141.4	Remote Condenser Unit for Cooler	Arclic Industries	COND C	1		
141.5	Evaporator for Freezer	Arclic Industries	EVAP F	1		
141.6	Remote Condenser Unit for Freezer	Arclic Industries	COND F	1		
141.7	Evaporator for Cooler	Arclic Industries	EVAP C	1		
141.8	Remote Condenser Unit for Cooler	Arclic Industries	COND C	1		
141.9	Evaporator for Freezer	Arclic Industries	EVAP F	1		
141.10	Remote Condenser Unit for Freezer	Arclic Industries	COND F	1		
151	Three (3) Compartment Sink	Advance Tabco	FC-3-1620	1		
151.1	Wall / Splash Mount Faucet	Krowne	14-812L	2		
152	Meat Bone Saw, Electric	Hobart	6614+BUILDUP	1		
153	Hand Sink	Advance Tabco	7-PS-66	1		
154	Work Table, Stainless Steel Top	Advance Tabco	KMS-306	2		

EQUIPMENT LAYOUT

All Dimensions to be verified on the job site. Actual locations for floor drains, and any ventilating equipment to be determined by Engineer. Mechanical, Plumbing & Electrical to be checked and verified by Customers MEP Engineer. Remote Condensing Units to be located by Architect. Exhaust & Supply fans to be located by Architect.

JEWEL GRANDE
Foodservice
 Montego Bay, Jamaica



INTERNATIONAL INC.

2055 W 73rd Street, Miami, FL 33016
 Ph: (305)826-8696 Fax: (305)826-9131

1	Preliminary Layout	4-06-26
2		
3		
4		
No.	Revision/Issue	Date

Date
April 06, 2026
 Drawn By
Dayne Gauntlett
 Scale
3/16" = 1'0"

Sheet
FS-1.1

Wine Room

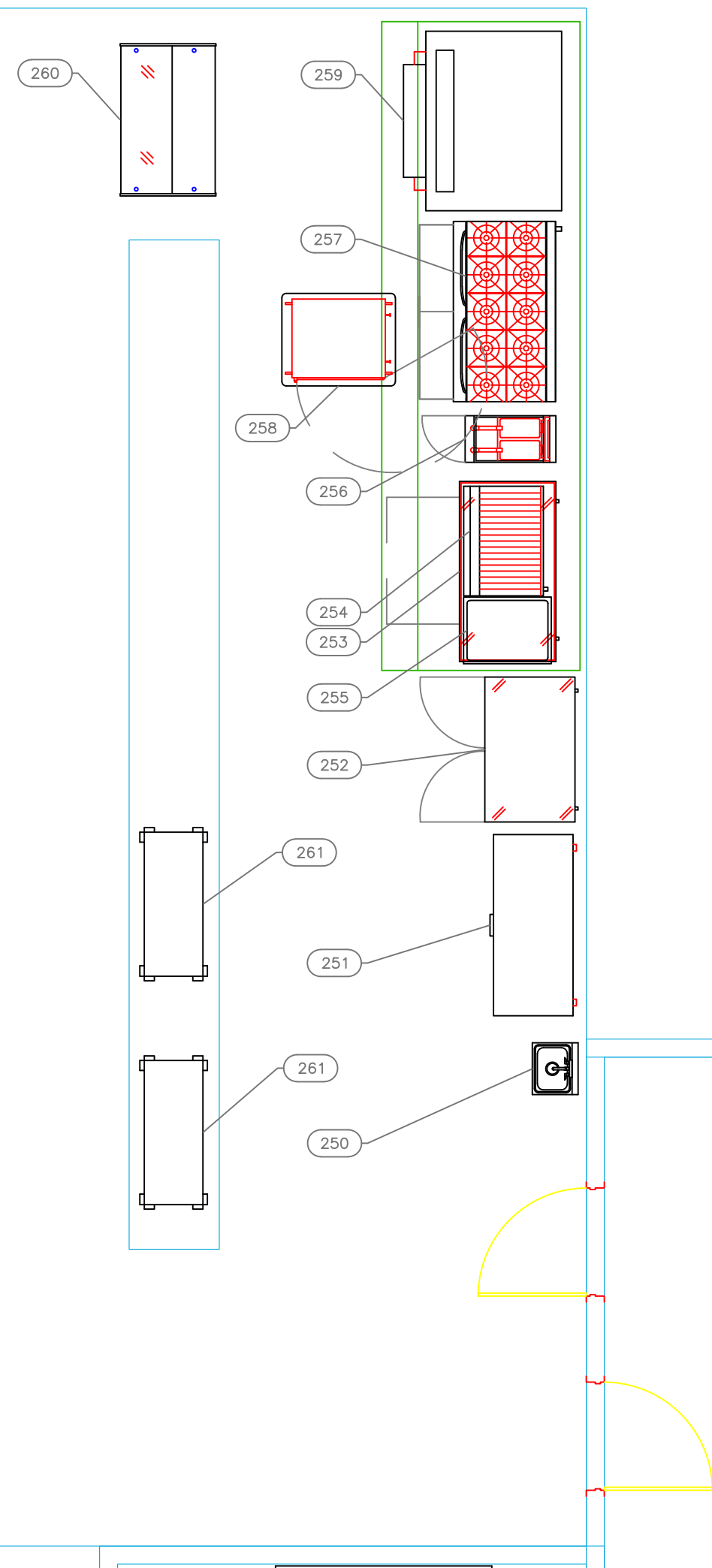

Club House Buffet

EQUIPMENT SCHEDULE					
ItemNo	Category	Mfr	Model	Quantity	Equipment Remarks
250	Hand Sink	Advance Tabco	7-PS-66	1	
251	Chest Freezer	Atosa USA, Inc.	MWF9016GR	1	
252	Undercounter Refrigerator	True Int'l - LATAM/Caribbean (USD)	TUC-48-HC	1	
253	Chef Base	True Int'l - LATAM/Caribbean (USD)	TRCB-52-60-HC	1	
254	Charbroiler, Gas, Countertop	Globe (Middleby)	GCB36G-RK	1	
255	Food Pan Warmer, Countertop	Serv-Ware	423FV200D	1	
256	Gas Floor Fryer	Vulcan	1GR45M	1	
257	Range, 60" 10 Open Burners	Southbend (Middleby)	S60DD	1	
258	Heated Banquet Cart	Alto-Shaam	1000-BQ296	1	
259	Fire Deck Oven, Gas	Wood Stone	FD-6045-RFG-R-IR	1	
260	Display Case, Refrigerated Bakery	Infrico USA	IDC-VON12PR	1	
261	Cold Shelf	Hatco	CSSBFP-48-I	2	

EQUIPMENT LAYOUT

All Dimensions to be verified on the job site.
 Actual locations for floor drains, and any ventilating equipment to be determined by Engineer.
 Mechanical, Plumbing & Electrical to be checked and verified by Customers MEP Engineer.
 Remote Condensing Units to be located by Architect.
 Exhaust & Supply fans to be located by Architect.

JEWEL GRANDE
 Foodservice
 Montego Bay, Jamaica



INTERNATIONAL INC.

2055 W 73rd Street, Miami, FL 33016
 Ph: (305)826-8696 Fax: (305)826-9131

No.	Revision/Issue	Date
1	Preliminary Layout	4-06-26
2		
3		
4		

Date
April 06, 2026
 Drawn By
Dayne Gauntlett
 Scale
1/4" = 1'0"

Sheet
FS-1.2

Club House Kitchen Mezzanine

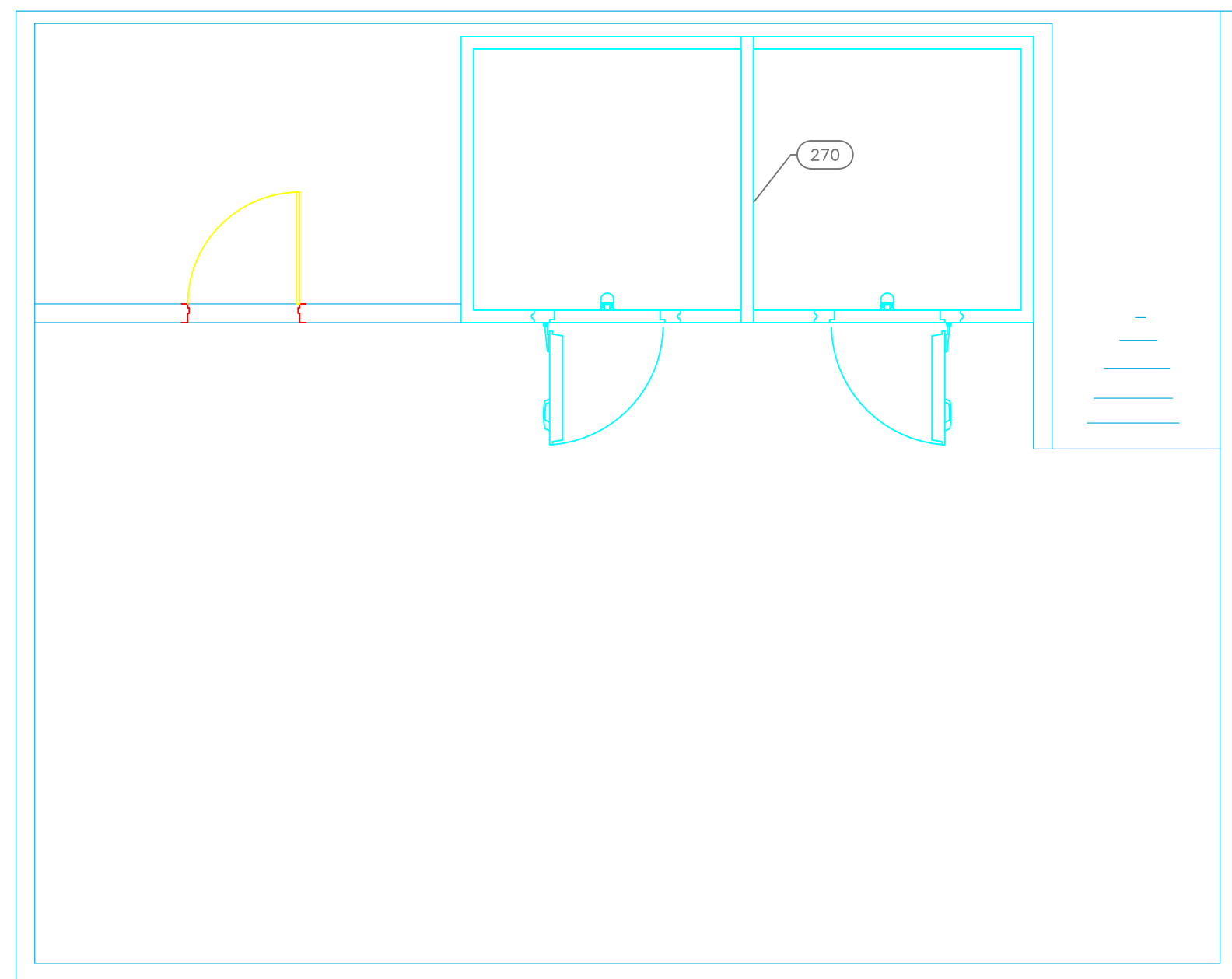

EQUIPMENT SCHEDULE					
ItemNo	Category	Mfr	Model	Quantity	Equipment Remarks
270	Walk-in Combo	Arctic Industries	WALK-IN COMBO	1	
270.1	Evaporator for Cooler	Arctic Industries	EVAP C	1	
270.2	Remote Condenser Unit for Cooler	Arctic Industries	COND C	1	
270.3	Evaporator for Freezer	Arctic Industries	EVAP F	1	
270.4	Remote Condenser Unit for Freezer	Arctic Industries	COND F	1	

EQUIPMENT LAYOUT

All Dimensions to be verified on the job site.
 Actual locations for floor drains, and any ventilating equipment to be determined by Engineer.
 Mechanical, Plumbing & Electrical to be checked and verified by Customers MEP Engineer.
 Remote Condensing Units to be located by Architect.
 Exhaust & Supply fans to be located by Architect.

JEWEL GRANDE
Foodservice
 Montego Bay, Jamaica



INTERNATIONAL INC.
 2055 W 73rd Street, Miami, FL 33016
 Ph: (305)826-8696 Fax: (305)826-9131

1	Preliminary Layout	4-06-26
2		
3		
4		
No.	Revision/Issue	Date

Date
April 06, 2026
 Drawn By
Dayne Gauntlett
 Scale
1/4" = 1'0"

Sheet
FS-1.3

Club House Room Service Level 2

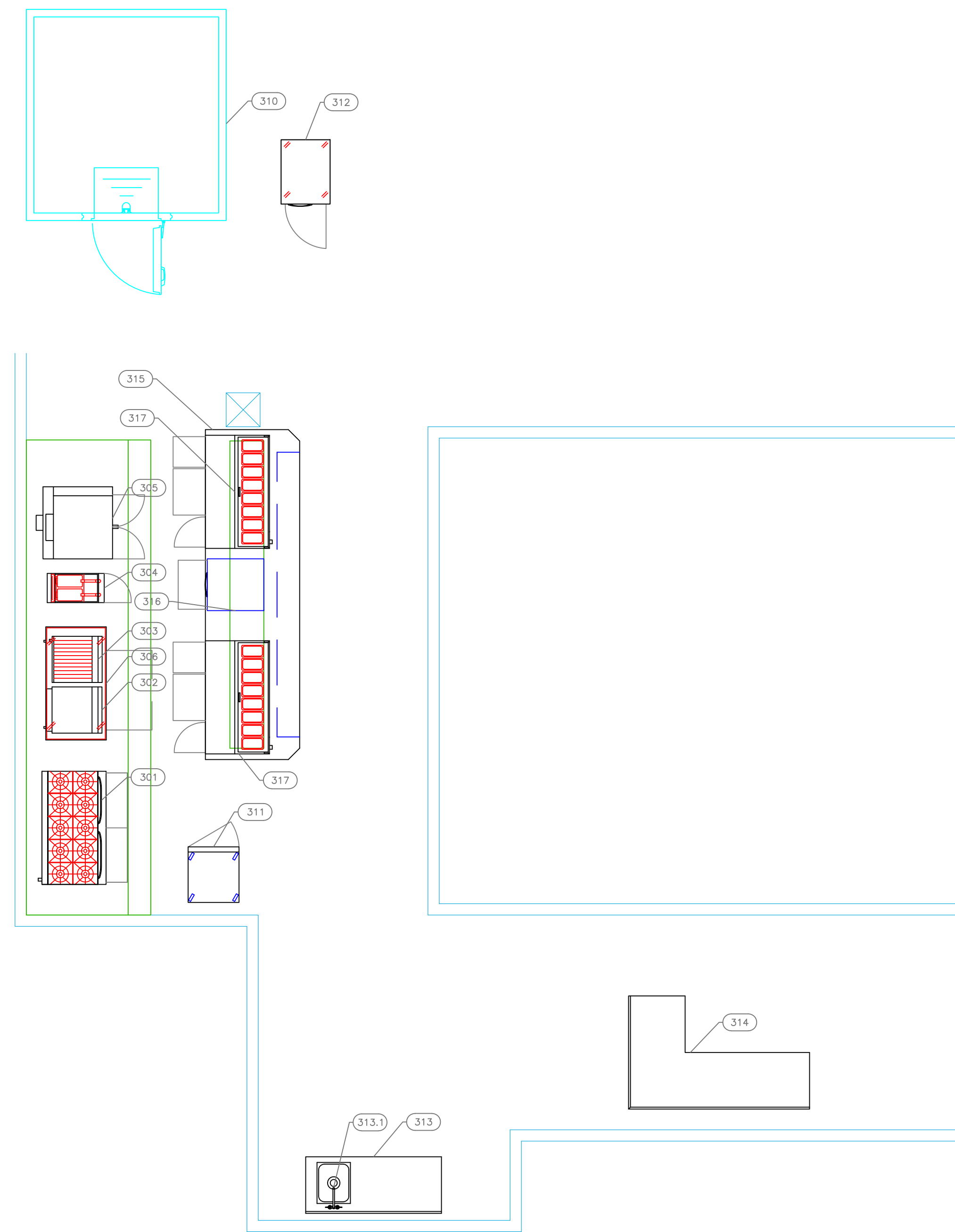

EQUIPMENT SCHEDULE					
ItemNo	Category	Mfr	Model	Quantity	Equipment Remarks
301	Range, 60", 10 Open Burners	Southbend (Middleby)	S60DD	1	
302	Griddle, Gas, Countertop	Globe (Middleby)	GG24G	1	
303	Charbroiler, Gas, Countertop	Globe (Middleby)	GC824G-CR	1	
304	Gas Floor Fryer	Vulcan	1GR45M	1	
305	Convection Oven, Electric	Blodgett (Middleby)	ZEPH-100-E SGL	1	
306	Chef Base	True Int'l - LATAM/Caribbean (USD)	TRCB-52-60-HC	1	
310	Walk-in Cooler	Arctic Industries	WALK-IN	1	
310.1	Evaporator for Cooler	Arctic Industries	EVAP C	1	
310.2	Remote Condenser Unit for Cooler	Arctic Industries	COND C	1	
311	Reach-In Freezer	True Int'l - LATAM/Caribbean (USD)	T-23F-HC	1	
312	Reach-In Dual Temp Cabinet	Continental Refrigerator	1RFNHD	1	
313	Work Table, with Prep Sink(s)	Advance Tabco	KMS-11B-306R	1	
313.1	Deck Mount Faucet	Krowne	15-410L	1	
314	Work Table, L-Shaped	Advance Tabco	KTMS-308	1	
315	Chef Table	Custom Fab	Q1971C-31	1	
	Heat Lamp	Nemco	6151-48	2	
	Heat Lamp	Nemco	6151-36	1	
316	Reach-In Undercounter Freezer	Continental Refrigerator	DF27N-U-D	1	
317	Pizza Preparation Refrigerator	Continental Refrigerator	PA60N-D	2	

EQUIPMENT LAYOUT

All Dimensions to be verified on the job site.
 Actual locations for floor drains, and any ventilating equipment to be determined by Engineer.
 Mechanical, Plumbing & Electrical to be checked and verified by Customers MEP Engineer.
 Remote Condensing Units to be located by Architect.
 Exhaust & Supply fans to be located by Architect.

JEWEL GRANDE
Foodservice
 Montego Bay, Jamaica

INTERNATIONAL INC.
 2055 W 73rd Street, Miami, FL 33016
 Ph: (305)826-8696 Fax: (305)826-9131

1	Preliminary Layout	4-06-26
2		
3		
4		
No.	Revision/Issue	Date

Date
April 06, 2026
 Drawn By
Dayne Gauntlett
 Scale
1/4" = 1'0"

Sheet
FS-1.4

Club House Lobby Bar

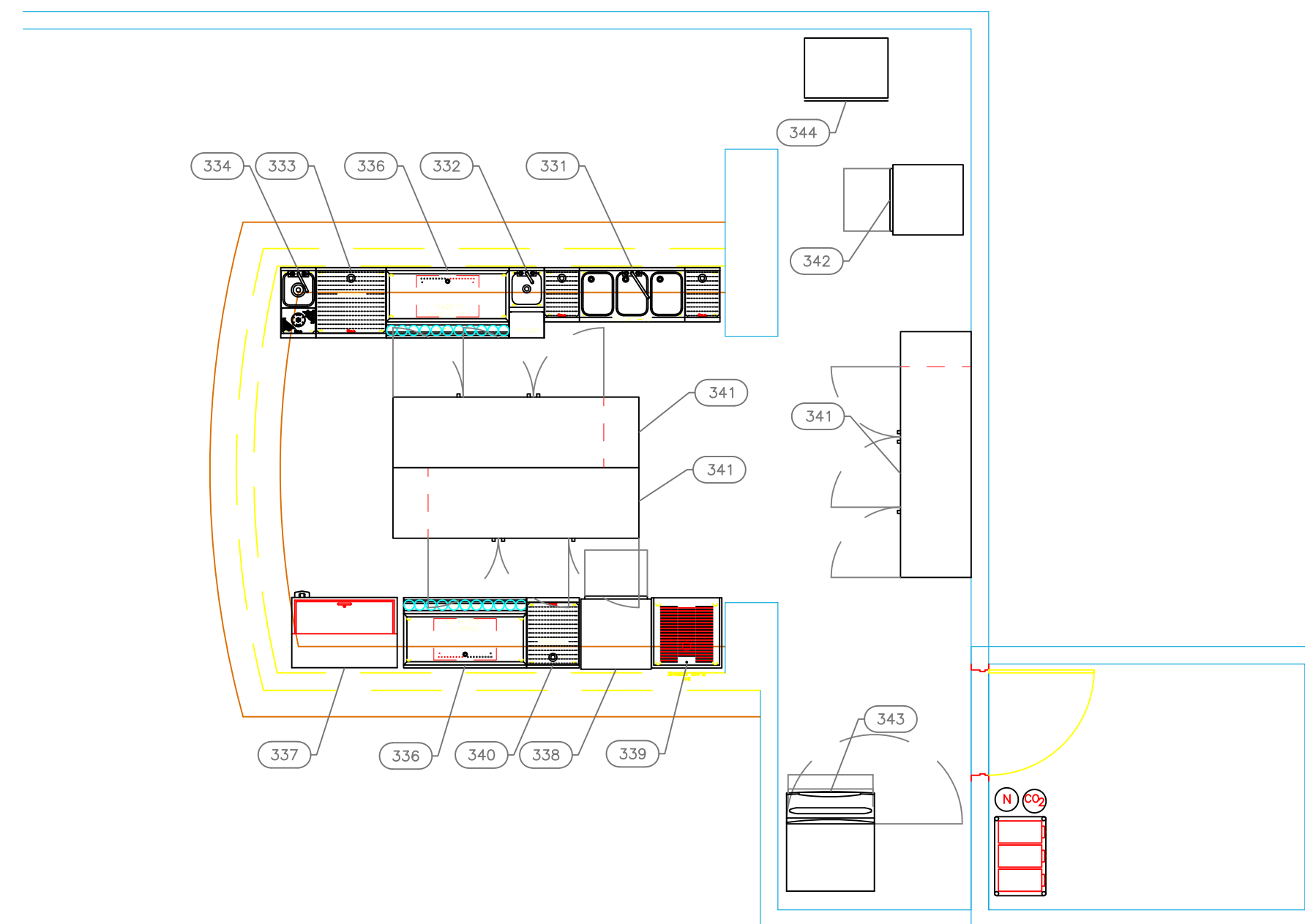

EQUIPMENT SCHEDULE					
ItemNo	Category	Mfr	Model	Quantity	Equipment Remarks
331	Underbar Sink Units	Perlick	TS60M3-DB	1	
332	Blender Station	Perlick	TSF12BS	1	
333	Drainboard	Perlick	TSF24DB	1	
334	Underbar Sink Units	Perlick	TSF12PS-SR-STK	1	
336	Ice Bin	Perlick	TS42IC10	2	
337	Bottle Cooler	Perlick	BC36RT-3	1	
338	Dishwasher, Undercounter	Champion	UH130B	1	
339	Glass Rack	Perlick	TSF24SC-GR	1	
340	Drainboard	Perlick	TSF18DB	1	
341	Back Bar Cabinet, Refrigerated, Pass-Thru	Perlick	PT584	3	
342	Dishwasher, Undercounter	CMA Dishmachines	180UC 3 W/DISPENSERS	1	
343	Ice Maker, Cube-Style	Manitowoc	IRT0500A	1	
	Ice Bin for Ice Machines	Manitowoc	D570	1	
344	Popcorn Popper	Gold Medal	2003ST	1	

EQUIPMENT LAYOUT

All Dimensions to be verified on the job site.
 Actual locations for floor drains, and any ventilating equipment to be determined by Engineer.
 Mechanical, Plumbing & Electrical to be checked and verified by Customers MEP Engineer.
 Remote Condensing Units to be located by Architect.
 Exhaust & Supply fans to be located by Architect.

JEWEL GRANDE
Foodservice
 Montego Bay, Jamaica



INTERNATIONAL INC.
 2055 W 73rd Street, Miami, FL 33016
 Ph: (305)826-8696 Fax: (305)826-9131

1	Preliminary Layout	4-06-26
2		
3		
4		
No.	Revision/Issue	Date

Date
April 06, 2026
 Drawn By
Dayne Gauntlett
 Scale
1/4" = 1'0"

Sheet
FS-1.5

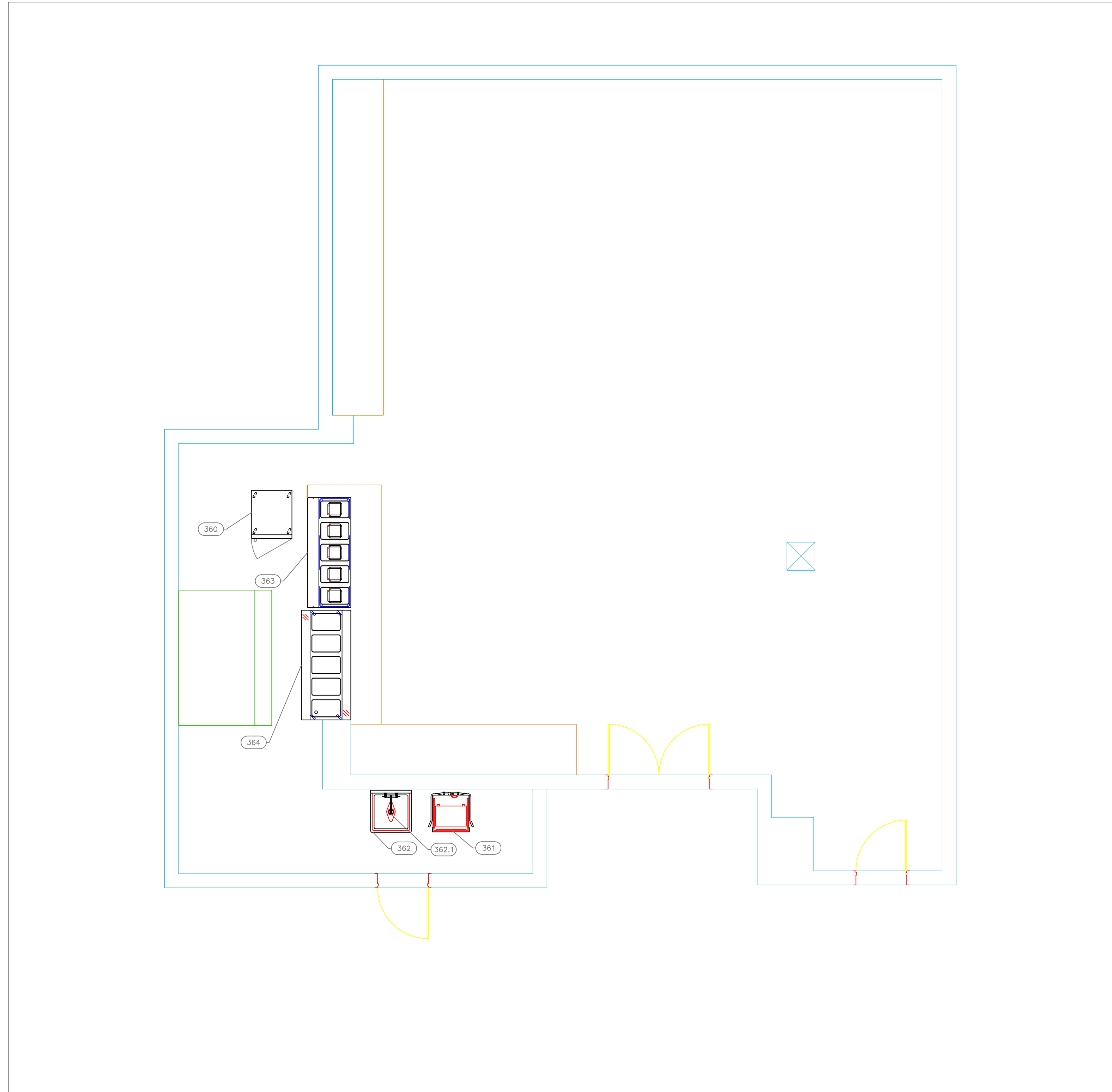

Irie Cafe

EQUIPMENT SCHEDULE					
ItemNo	Category	Mfr	Model	Quantity	Equipment Remarks
360	Reach-In Refrigerator	True Int'l - LATAM/Caribbean (USD)	TGN-1R-1S	1	
361	Dishwasher, Door Type	Champion	DH-3000 (40-70)	1	
362	One (1) Compartment Sink	Advance Tabco	FC-1-2424	1	
362.1	Wall / Splash Mount Faucet	Krowne	14-812L	1	
363	Hot Food Serving Counter / Table	Advance Tabco	HF-5G-LP	1	
364	Serving Counter, Cold Food	Advance Tabco	BS-CPU-B	1	

EQUIPMENT LAYOUT

All Dimensions to be verified on the job site.
 Actual locations for floor drains, and any ventilating equipment to be determined by Engineer.
 Mechanical, Plumbing & Electrical to be checked and verified by Customers MEP Engineer.
 Remote Condensing Units to be located by Architect.
 Exhaust & Supply fans to be located by Architect.

JEWEL GRANDE
 Foodservice
 Montego Bay, Jamaica



INTERNATIONAL INC.

2055 W 73rd Street, Miami, FL 33016
 Ph: (305)826-8696 Fax: (305)826-9131

1	Preliminary Layout	4-06-26
2		
3		
4		
No.	Revision/Issue	Date

Date
April 06, 2026
 Drawn By
Dayne Gauntlett
 Scale
1/4" = 1'0"

Sheet
FS-1.6

Crickets Bar

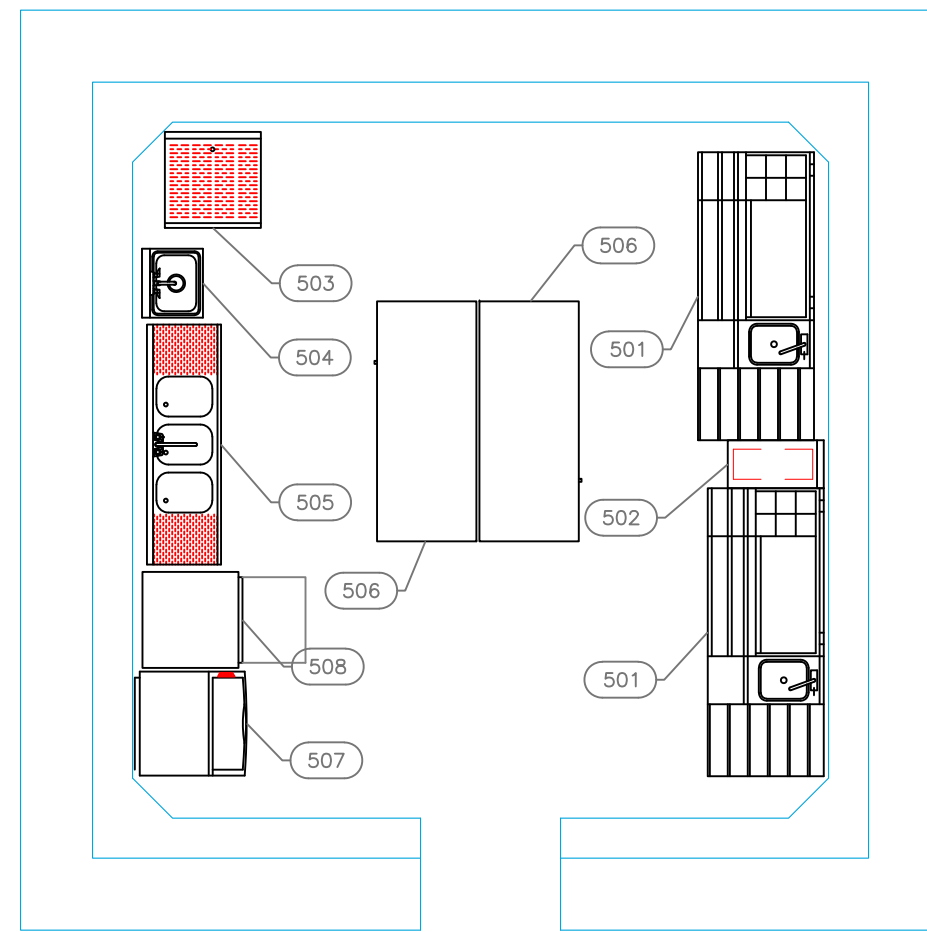

EQUIPMENT SCHEDULE					
ItemNo	Category	Mfr	Model	Quantity	Equipment Remarks
501	Cocktail Station	Eagle Group	CCS-72-1	2	
502	Chest Freezer	Krowne	KR24-12CSF	1	
503	Glass Rack	Krowne	KR24-GSB1	1	
504	Hand Sink	Advance Tabco	7-PS-66	1	
505	Underbar Sink Units	Krowne	18-53C	1	
506	Back Bar Cabinet, Refrigerated	True Int'l - LATAM/Caribbean (USD)	TBR60-RISZ1-L-B-11-1	2	
507	Ice Maker with Bin, Cube-Style	Manitowoc	UYF0140A	1	
508	Dishwasher, Undercounter	Champion	UH130B	1	

EQUIPMENT LAYOUT

All Dimensions to be verified on the job site.
 Actual locations for floor drains, and any ventilating equipment to be determined by Engineer.
 Mechanical, Plumbing & Electrical to be checked and verified by Customers MEP Engineer.
 Remote Condensing Units to be located by Architect.
 Exhaust & Supply fans to be located by Architect.

JEWEL GRANDE
Foodservice
 Montego Bay, Jamaica



INTERNATIONAL INC.

2055 W 73rd Street, Miami, FL 33016
 Ph: (305)826-8696 Fax: (305)826-9131

1	Preliminary Layout	4-06-26
2		
3		
4		
No.	Revision/Issue	Date

Date
April 06, 2026
 Drawn By
Dayne Gauntlett
 Scale
1/4" = 1'0"

Sheet
FS-1.7

Crickets Kitchen

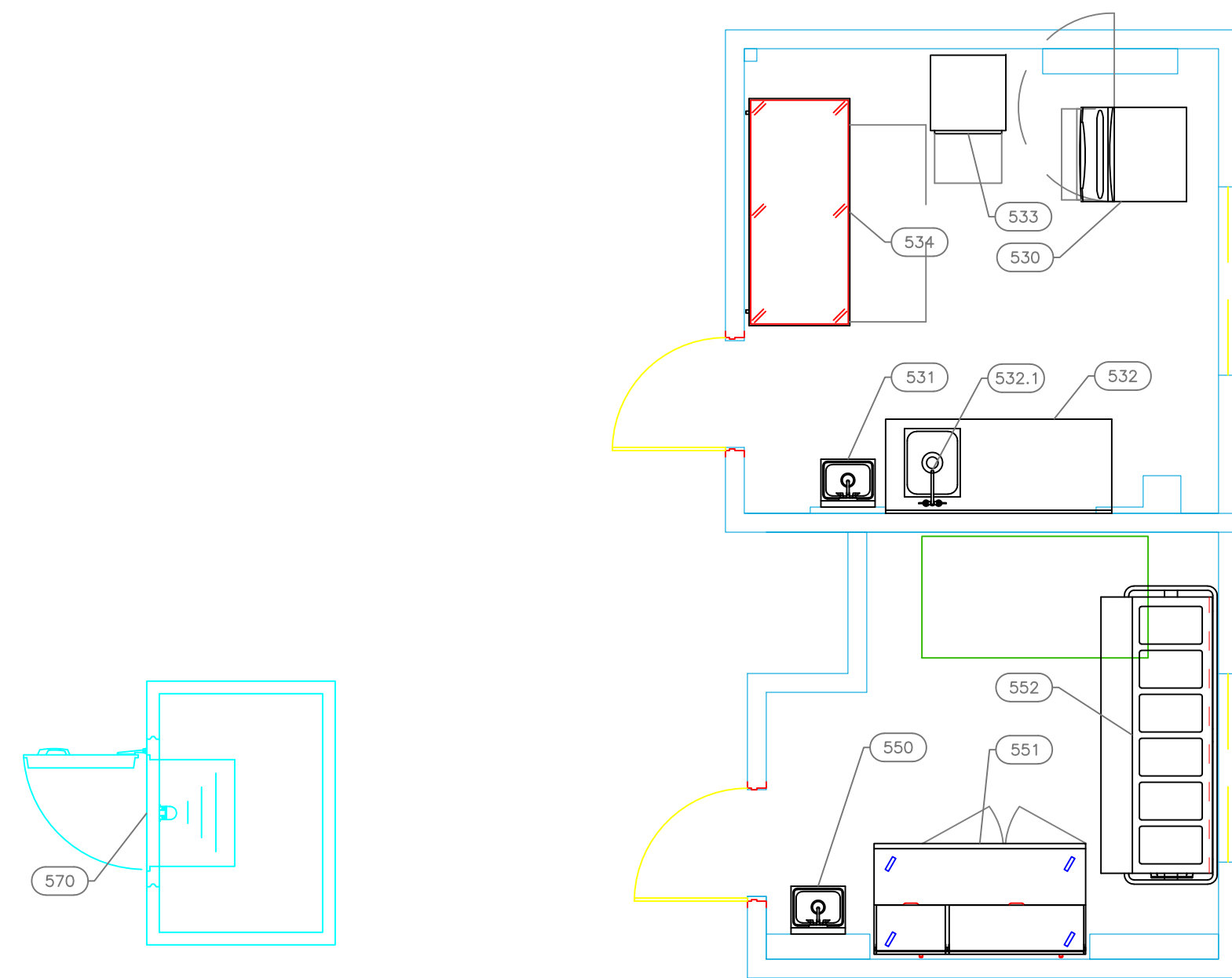

EQUIPMENT SCHEDULE					
ItemNo	Category	Mfr	Model	Quantity	Equipment Remarks
530	Ice Maker, Cube-Style	Manitowoc	IRT0500A	1	
	Ice Bin for Ice Machines	Manitowoc	D570	1	
531	Hand Sink	Advance Tabco	7-PS-66	1	
532	Work Table, with Prep Sink(s)	Advance Tabco	KMS-11B-306R	1	
532.1	Deck Mount Faucet	Krowne	15-410L	1	
533	Dishwasher, Undercounter	CMA Dishmachines	180UC 3 W/DISPENSERS	1	
534	Chef Base	True Int'l - LATAM/Caribbean (USD)	TRCB-72-HC	1	
550	Hand Sink	Advance Tabco	7-PS-66	1	
551	Pizza Preparation Refrigerator	True Int'l - LATAM/Caribbean (USD)	TPP-AT-67-HC	1	
552	Hot Food Serving Counter / Table	Duke	EPW-6-CBSS	1	
570	Walk-In Cooler	Arctic Industries	WALK-IN	1	
570.1	Evaporator for Cooler	Arctic Industries	EVAP C	1	
570.2	Remote Condenser Unit for Cooler	Arctic Industries	COND C	1	

EQUIPMENT LAYOUT

All Dimensions to be verified on the job site.
 Actual locations for floor drains, and any ventilating equipment to be determined by Engineer.
 Mechanical, Plumbing & Electrical to be checked and verified by Customers MEP Engineer.
 Remote Condensing Units to be located by Architect.
 Exhaust & Supply fans to be located by Architect.

JEWEL GRANDE
Foodservice
 Montego Bay, Jamaica



INTERNATIONAL INC.

2055 W 73rd Street, Miami, FL 33016
 Ph: (305)826-8696 Fax: (305)826-9131

1	Preliminary Layout	4-06-26
2		
3		
4		
No.	Revision/Issue	Date

Date
April 06, 2026
 Drawn By
Dayne Gauntlett
 Scale
1/4" = 1'0"

Sheet
FS-1.8

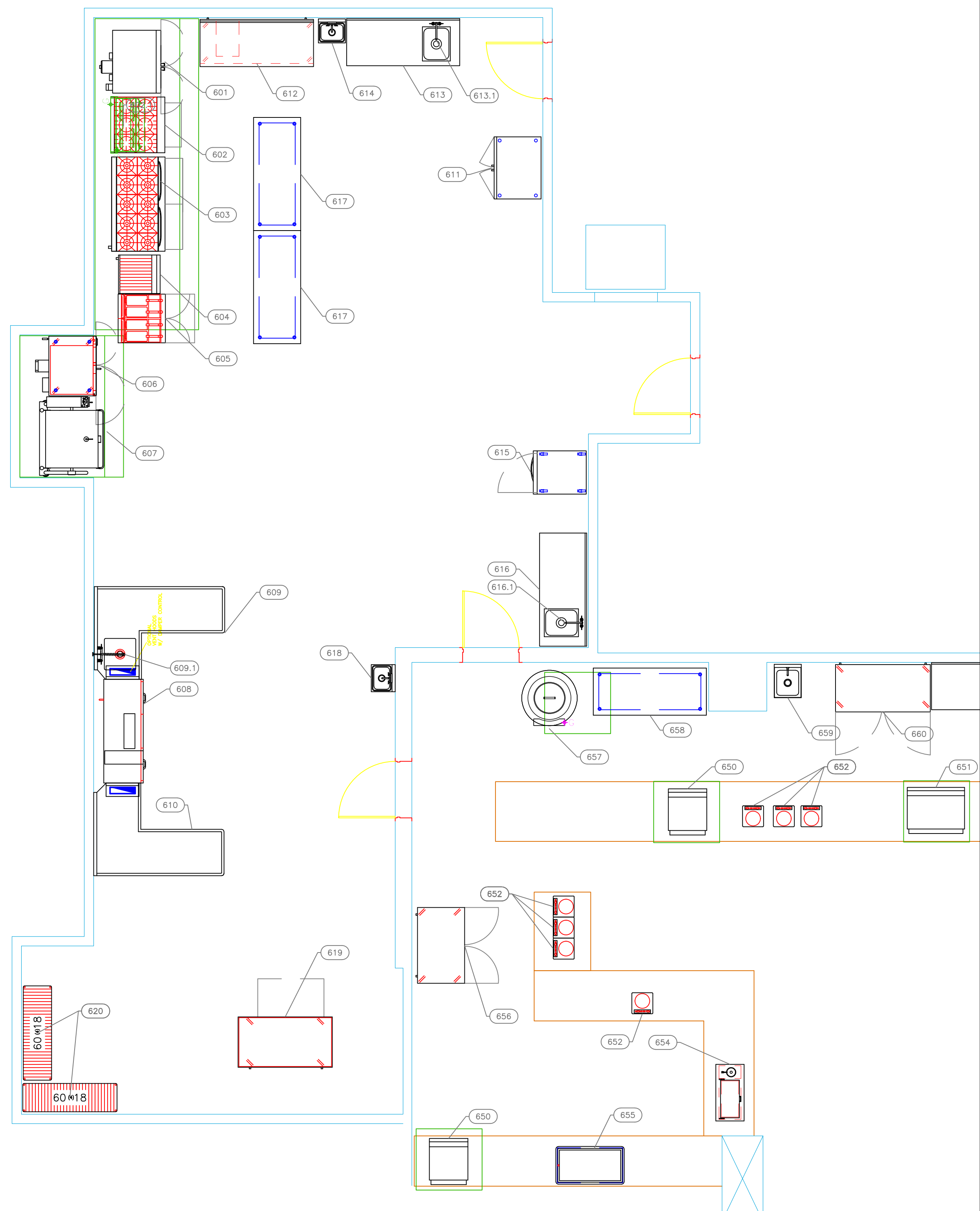

Orchid Kitchen

EQUIPMENT SCHEDULE					
ItemNo	Category	Mfr	Model	Quantity	Equipment Remarks
601	Convection Oven, Gas	Vulcan	VC44GD	1	
602	Range, 36", 6 Open Burners	Garland Commercial Ranges	U36-6R	1	
602.1	Salamander Broiler, Gas	Garland Commercial Ranges	UIR36	1	
603	Range, 60", 10 Open Burners	Southbend (Middleby)	S60DD	1	
604	Charbroiler, Gas, Countertop	Globe (Middleby)	GCB24G-CR	1	
605	Gas Fryer, Battery	Vulcan	2GR45MF	1	
606	Convection Oven, Gas	Southbend (Middleby)	PCG1003/SD	1	
607	Tilting Skillet Braising Pan, Gas	Cleveland	SGL40T1NATHTPOS	1	
608	Dishwasher, Conveyor Type	CMA Dishmachines	EST-66	1	
609	Dishtable, Soiled "L" Shaped	Advance Tabco	DTS-G30-84R	1	
609.1	Pre-Rinse Faucet Assembly	Krowne	17-108WL	1	
610	Dishtable, Clean "L" Shaped	Advance Tabco	DTC-G30-84L	1	
611	Refrigerated Merchandiser	True Int'l - LATAM/Caribbean (USD)	GDM-35-HC-TSL01	1	
612	Refrigerated Work Top	True Int'l - LATAM/Caribbean (USD)	TWT-72-HC	1	
613	Work Table, with Prep Sink(s)	Advance Tabco	KMS-11B-306R	1	
613.1	Deck Mount Faucet	Krowne	15-410L	1	
614	Hand Sink	Advance Tabco	7-PS-66	1	
615	Reach-In Refrigerator	True Int'l - LATAM/Caribbean (USD)	STA1R-1S-HC	1	
616	Work Table, with Prep Sink(s)	Advance Tabco	KMS-11B-306R	1	
616.1	Deck Mount Faucet	Krowne	15-410L	1	
617	Work Table, Stainless Steel Top	Advance Tabco	MS-306	2	
618	Hand Sink	Advance Tabco	7-PS-66	1	
619	Chef Base	True Int'l - LATAM/Caribbean (USD)	TRCB-52-60-HC	1	

EQUIPMENT LAYOUT

All Dimensions to be verified on the job site.
 Actual locations for floor drains, and any ventilating equipment to be determined by Engineer.
 Mechanical, Plumbing & Electrical to be checked and verified by Customers MEP Engineer.
 Remote Condensing Units to be located by Architect.
 Exhaust & Supply fans to be located by Architect.

JEWEL GRANDE
Foodservice
 Montego Bay, Jamaica



INTERNATIONAL INC.

2055 W 73rd Street, Miami, FL 33016
 Ph: (305)826-8696 Fax: (305)826-9131

1	Preliminary Layout	4-06-26
2		
3		
4		
No.	Revision/Issue	Date

Date
April 06, 2026
 Drawn By
Dayne Gauntlett
 Scale
1/4" = 1'0"

Sheet
FS-1.9

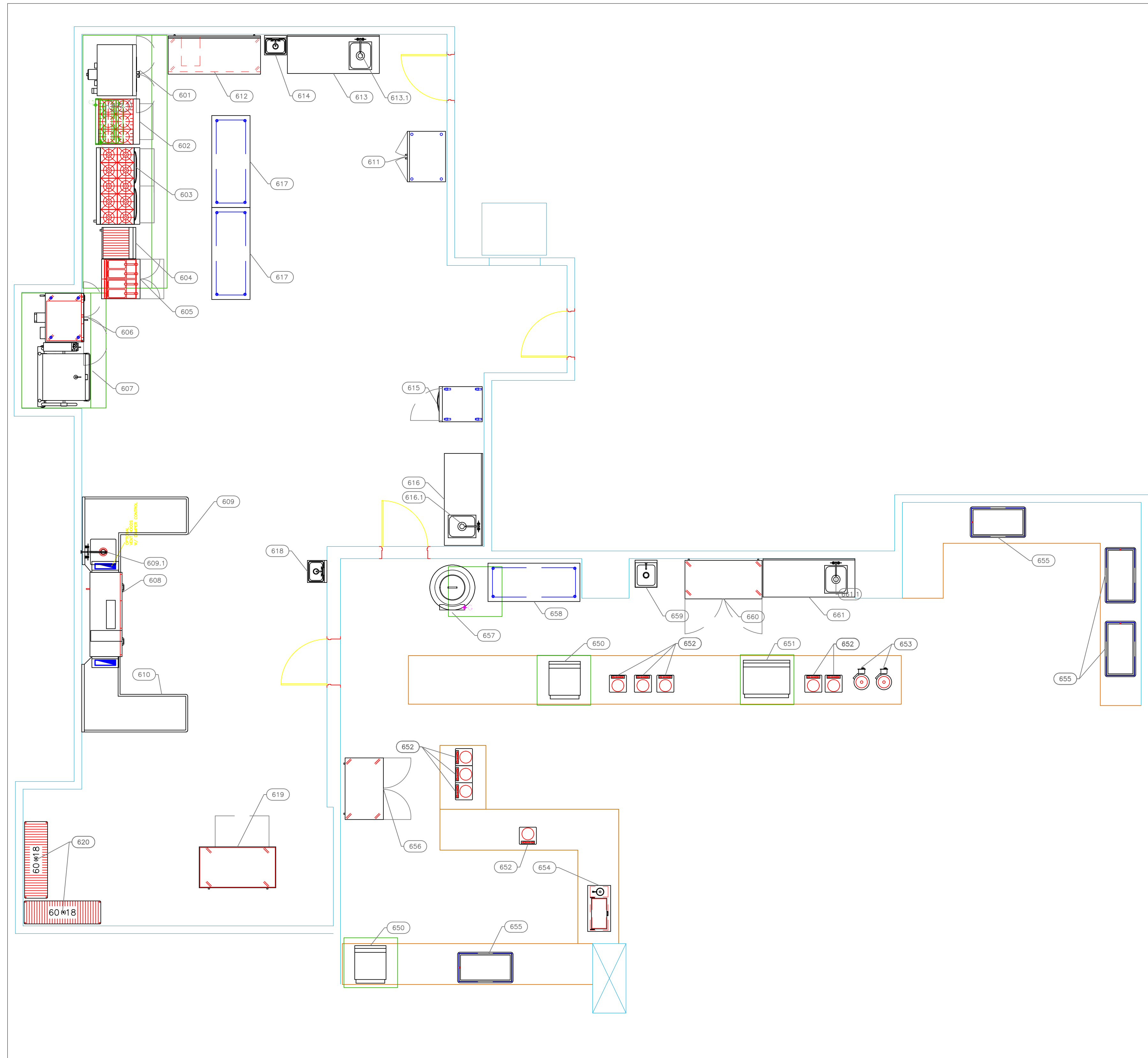

EQUIPMENT SCHEDULE					
ItemNo	Category	Mfr	Model	Quantity	Equipment Remarks
620	Shelving Unit, All Plastic	Quantum	QP186050SS-4	1	
650	Griddle, Gas, Countertop	Globe (Middleby)	GG24G	2	
651	Griddle, Gas, Countertop	Globe (Middleby)	GG36G	1	
652	Induction Range- Built-In / Drop-In	Equipex	GL1800 DI	9	
653	Hot Food Well Unit, Drop-In, Electric	Wells (Middleby)	HW-106D	2	
654	Ice Cream Dipping Cabinet	Glastender	DI-FR36-DW	1	
655	Frost Top / Cold Slab, Drop In	Atlas Metal	WF-3	4	
656	Undercounter Refrigerator	True Int'l - LATAM/Caribbean (USD)	TUC-48-HC	1	
657	Barrel Tandoor	Beech Ovens (Middleby)	TBR0500-C	1	
658	Work Table, Stainless Steel Top	Advance Tabco	MS-306	1	
659	Hand Sink	Advance Tabco	7-PS-18	1	
660	Undercounter Refrigerator	True Int'l - LATAM/Caribbean (USD)	TUC-66-HC	1	
661	Work Table, with Prep Sink(s)	Advance Tabco	KMS-11B-306R	1	
661.1	Deck Mount Faucet	Krowne	15-410L	1	

Orchid Buffet

EQUIPMENT LAYOUT

All Dimensions to be verified on the job site.
 Actual locations for floor drains, and any ventilating equipment to be determined by Engineer.
 Mechanical, Plumbing & Electrical to be checked and verified by Customers MEP Engineer.
 Remote Condensing Units to be located by Architect.
 Exhaust & Supply fans to be located by Architect.

JEWEL GRANDE
 Foodservice
 Montego Bay, Jamaica

INTERNATIONAL INC.
 2055 W 73rd Street, Miami, FL 33016
 Ph: (305)826-8696 Fax: (305)826-9131

1	Preliminary Layout	4-06-26
2		
3		
4		
No.	Revision/Issue	Date

Date
April 06, 2026
 Drawn By
Dayne Gauntlett
 Scale
1/4" = 1'0"

Sheet
FS-1.10

Sentry Lobby Bar

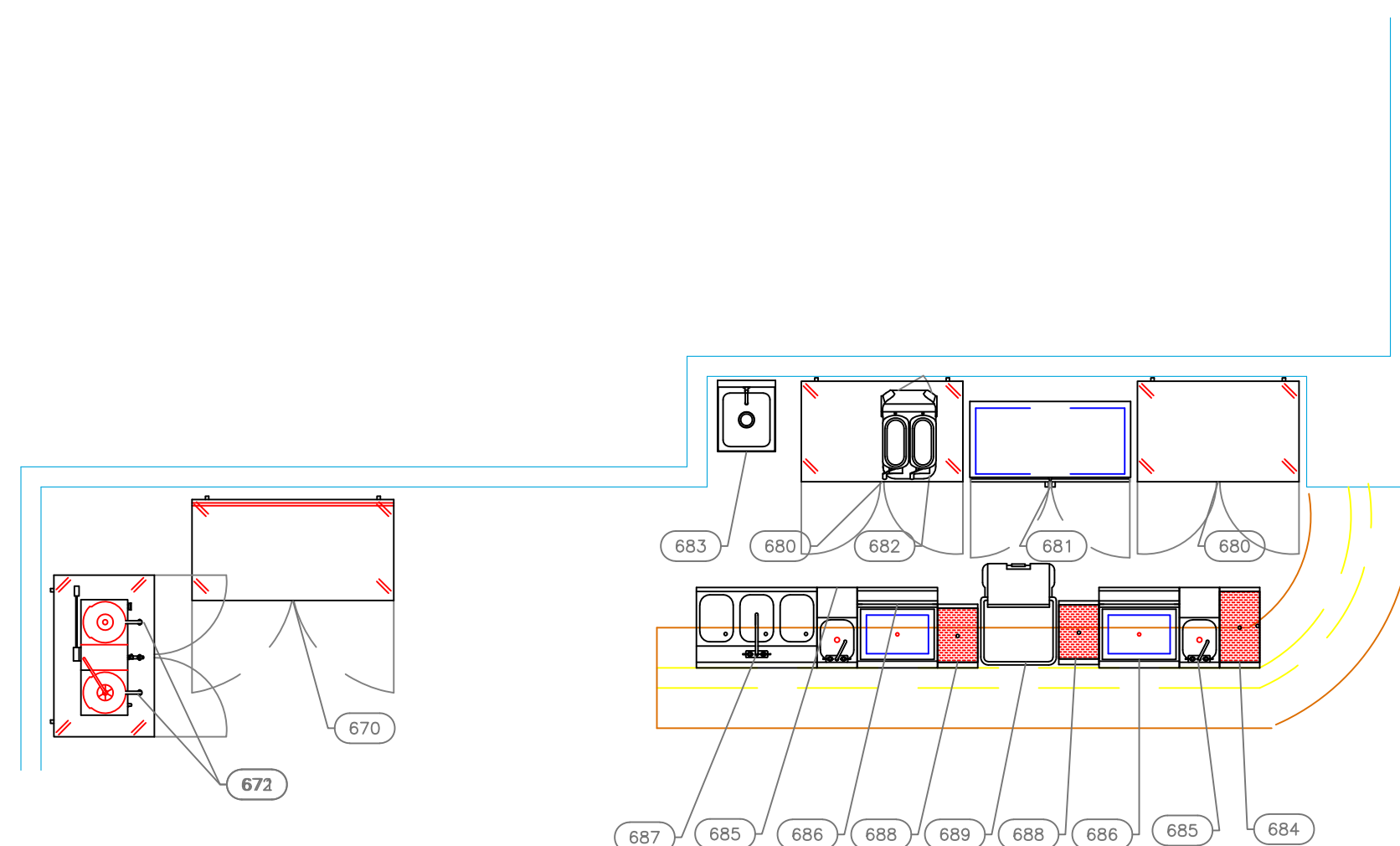

EQUIPMENT SCHEDULE					
ItemNo	Category	Mfr	Model	Quantity	Equipment Remarks
670	Refrigerated Work Top	True Int'l - LATAM/Caribbean (USD)	TWT-60-HC	1	
671	Undercounter Refrigerator	True Int'l - LATAM/Caribbean (USD)	TUC-48-HC	1	
672	Coffee Maker / Brewer Urn	BUNN	20500.0000	1	
680	Undercounter Refrigerator	True Int'l - LATAM/Caribbean (USD)	TUC-48-HC	2	
681	Back Bar Cabinet, Non-Refrigerated	Krowne	BD48	1	
682	Frozen Drink Machine, Non-Carbonated, Bowl Type	BUNN	58000.0000	1	
683	Hand Sink	Advance Tabco	7-PS-18	1	
684	Drainboard	Krowne	KR24-RG12	1	
685	Blender Station	Krowne	KR24-12BD	2	
686	Ice Bin	Krowne	KR19-24-10	2	
687	Underbar Sink Units	Krowne	KR24-33C	1	
688	Drainboard	Krowne	KR19-GS12	2	
689	Ice Bin / Ice Caddy, Mobile	Cambro	ICS100L110	1	

EQUIPMENT LAYOUT

All Dimensions to be verified on the job site.
 Actual locations for floor drains, and any ventilating equipment to be determined by Engineer.
 Mechanical, Plumbing & Electrical to be checked and verified by Customers MEP Engineer.
 Remote Condensing Units to be located by Architect.
 Exhaust & Supply fans to be located by Architect.

JEWEL GRANDE
Foodservice
 Montego Bay, Jamaica



INTERNATIONAL INC.

2055 W 73rd Street, Miami, FL 33016
 Ph: (305)826-8696 Fax: (305)826-9131

1	Preliminary Layout	4-06-26
2		
3		
4		
No.	Revision/Issue	Date

Date
April 06, 2026
 Drawn By
Dayne Gauntlett
 Scale
1/4" = 1'0"

Sheet
FS-1.11

Sentry Coffee

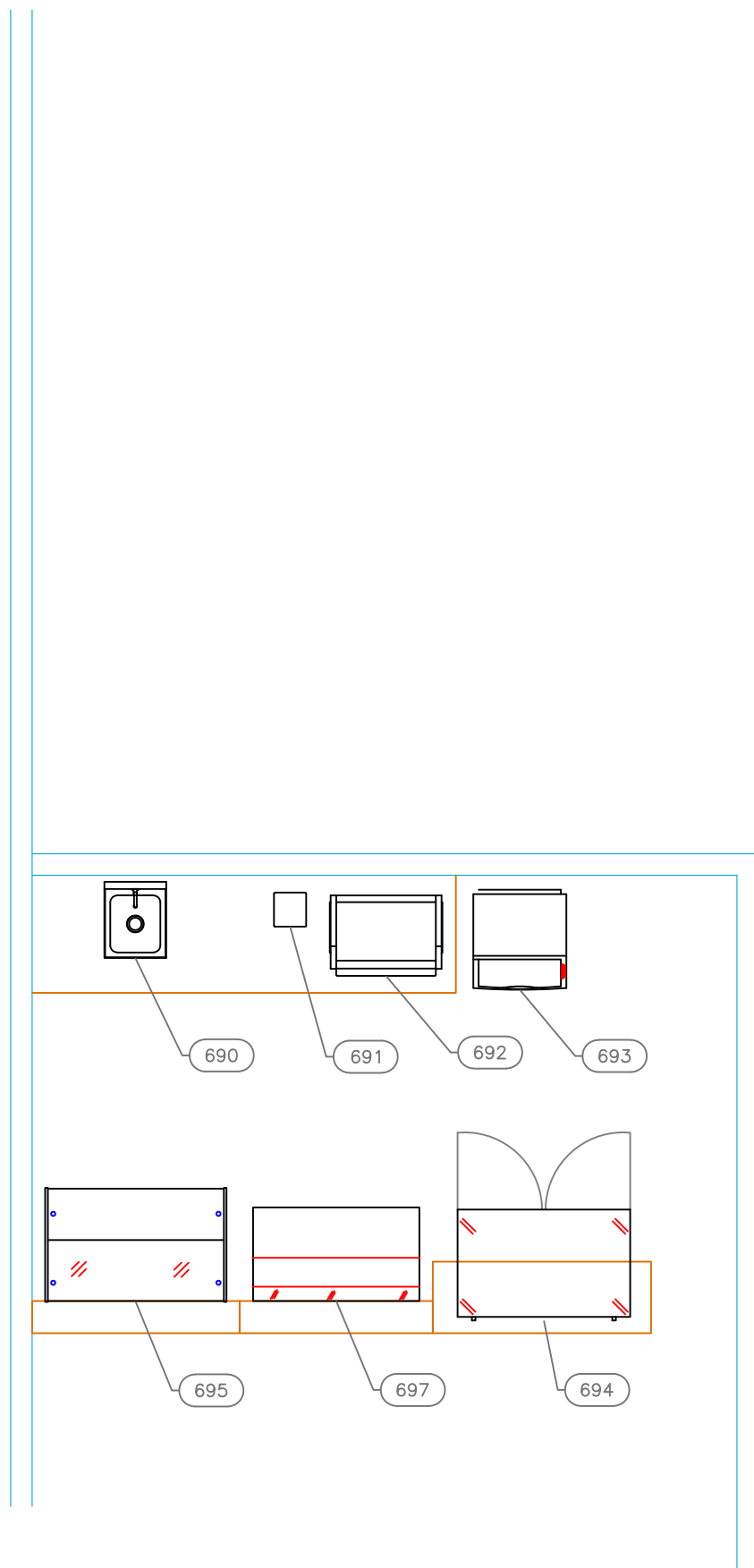

EQUIPMENT SCHEDULE					
ItemNo	Category	Mfr	Model	Quantity	Equipment Remarks
690	Hand Sink	Advance Tabco	7-PS-18	1	
691	Blender, Bar	Waring	MX1500XTX	1	
692	Espresso Cappuccino Machine	RositoBisani	TECNICA FS 2 GROUP	1	
693	Ice Maker with Bin, Cube-Style	Manitowoc	UYF0140A	1	
694	Undercounter Refrigerator	True Int'l - LATAM/Caribbean (USD)	TUC-48-HC	1	
695	Display Case, Refrigerated Bakery	Infrico USA	IDC-VON12PR	1	
697	Display Case, Dipping, Gelato/Ice Cream	Global Refrigeration	52-1802-70-R15	1	

EQUIPMENT LAYOUT

All Dimensions to be verified on the job site.
 Actual locations for floor drains, and any ventilating equipment to be determined by Engineer.
 Mechanical, Plumbing & Electrical to be checked and verified by Customers MEP Engineer.
 Remote Condensing Units to be located by Architect.
 Exhaust & Supply fans to be located by Architect.

JEWEL GRANDE
Foodservice
 Montego Bay, Jamaica



2055 W 73rd Street, Miami, FL 33016
 Ph: (305)826-8696 Fax: (305)826-9131

1	Preliminary Layout	4-06-26
2		
3		
4		
No.	Revision/Issue	Date

Date
April 06, 2026
 Drawn By
Dayne Gauntlett
 Scale
1/4" = 1'0"

Sheet
FS-1.12

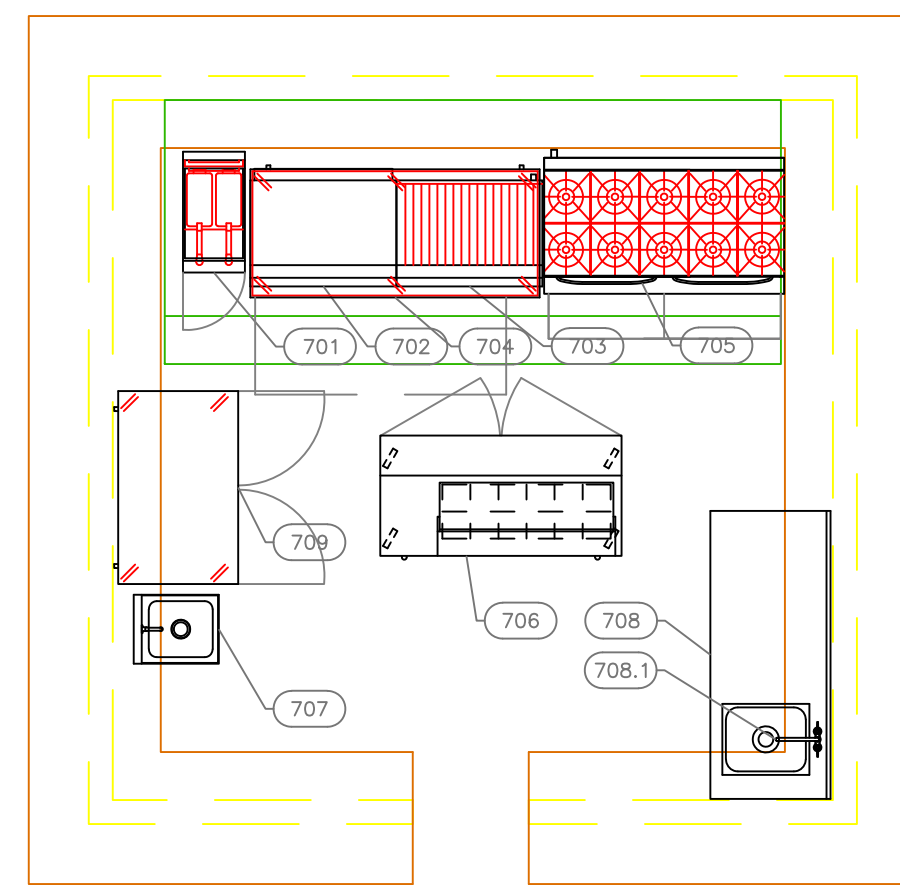

Pelican Grill

EQUIPMENT SCHEDULE					
ItemNo	Category	Mfr	Model	Quantity	Equipment Remarks
701	Gas Floor Fryer	Vulcan	1GR45M	1	
702	Griddle, Gas, Countertop	Globe (Middleby)	GG36G	1	
703	Charbroiler, Gas, Countertop	Globe (Middleby)	GC836G-CR	1	
704	Chef Base	True Int'l - LATAM/Caribbean (USD)	TRCB-72+HC	1	
705	Range, 60", 10 Open Burners	Southbend (Middleby)	S60DD	1	
706	Sandwich / Salad Preparation Refrigerator	True Int'l - LATAM/Caribbean (USD)	TSSU-60-12+HC	1	
707	Hand Sink	Advance Tabco	7-PS-18	1	
708	Work Table, with Prep Sink(s)	Advance Tabco	KMS-11B-306R	1	
708.1	Deck Mount Faucet	Krowne	15-410L	1	
709	Undercounter Refrigerator	True Int'l - LATAM/Caribbean (USD)	TUC-48-HC	1	

EQUIPMENT LAYOUT

All Dimensions to be verified on the job site.
 Actual locations for floor drains, and any ventilating equipment to be determined by Engineer.
 Mechanical, Plumbing & Electrical to be checked and verified by Customers MEP Engineer.
 Remote Condensing Units to be located by Architect.
 Exhaust & Supply fans to be located by Architect.

JEWEL GRANDE
Foodservice
 Montego Bay, Jamaica



INTERNATIONAL INC.

2055 W 73rd Street, Miami, FL 33016
 Ph: (305)826-8696 Fax: (305)826-9131

1	Preliminary Layout	4-06-26
2		
3		
4		
No.	Revision/Issue	Date

Date
April 06, 2026
 Drawn By
Dayne Gauntlett
 Scale
1/4" = 1'0"

Sheet
FS-1.13

Century Pool Bar Rum Runner

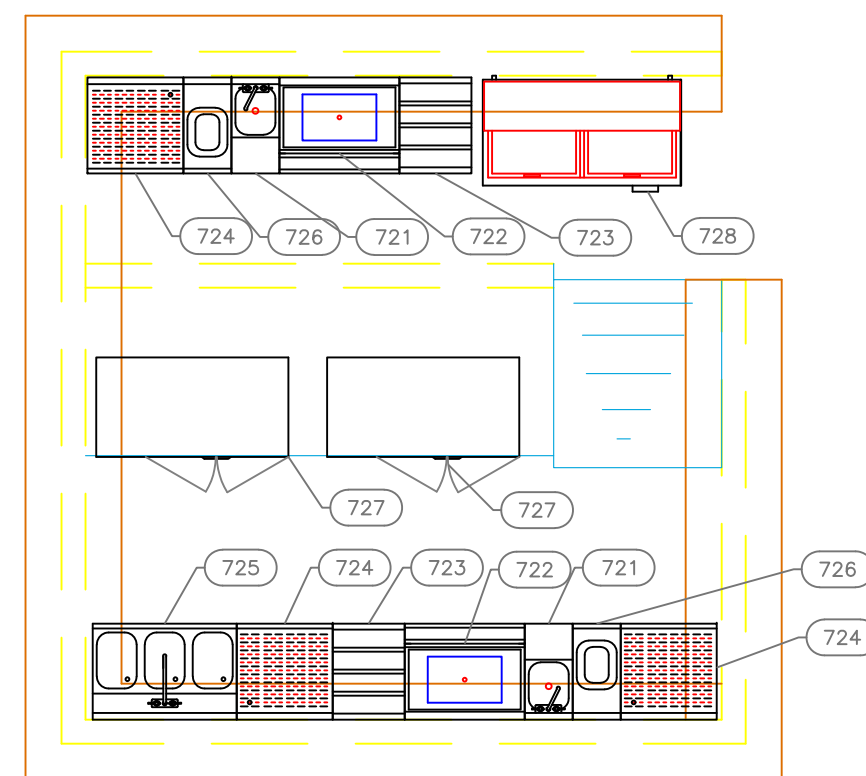

EQUIPMENT SCHEDULE					
ItemNo	Category	Mfr	Model	Quantity	Equipment Remarks
721	Blender Station	Krowne	KR24-12BD	2	
722	Ice Bin	Krowne	KR19-30-10	2	
723	Bottle Storage Unit	Krowne	KR24-18RD	2	
724	Glass Rack	Krowne	KR24-GSB3	3	
725	Underbar Sink Units	Krowne	KR24-33C	1	
726	Underbar Add-On Unit	Krowne	KR24-T12	2	
727	Back Bar Cabinet, Refrigerated	True Int'l - LATAM/Caribbean (USD)	TBB24-48-2S-Z1-SFT-S-1	2	
728	Bottle Cooler	True Int'l - LATAM/Caribbean (USD)	TD-50-18-S-HC	1	

EQUIPMENT LAYOUT

All Dimensions to be verified on the job site.
Actual locations for floor drains, and any ventilating equipment to be determined by Engineer.
Mechanical, Plumbing & Electrical to be checked and verified by Customers MEP Engineer.
Remote Condensing Units to be located by Architect.
Exhaust & Supply fans to be located by Architect.

JEWEL GRANDE
Foodservice
Montego Bay, Jamaica



INTERNATIONAL INC.
2055 W 73rd Street, Miami, FL 33016
Ph: (305)826-8696 Fax: (305)826-9131

1	Preliminary Layout	4-06-26
2		
3		
4		
No.	Revision/Issue	Date

Date
April 06, 2026
Drawn By
Dayne Gauntlett
Scale
1/4" = 1'0"

Sheet
FS-1.14

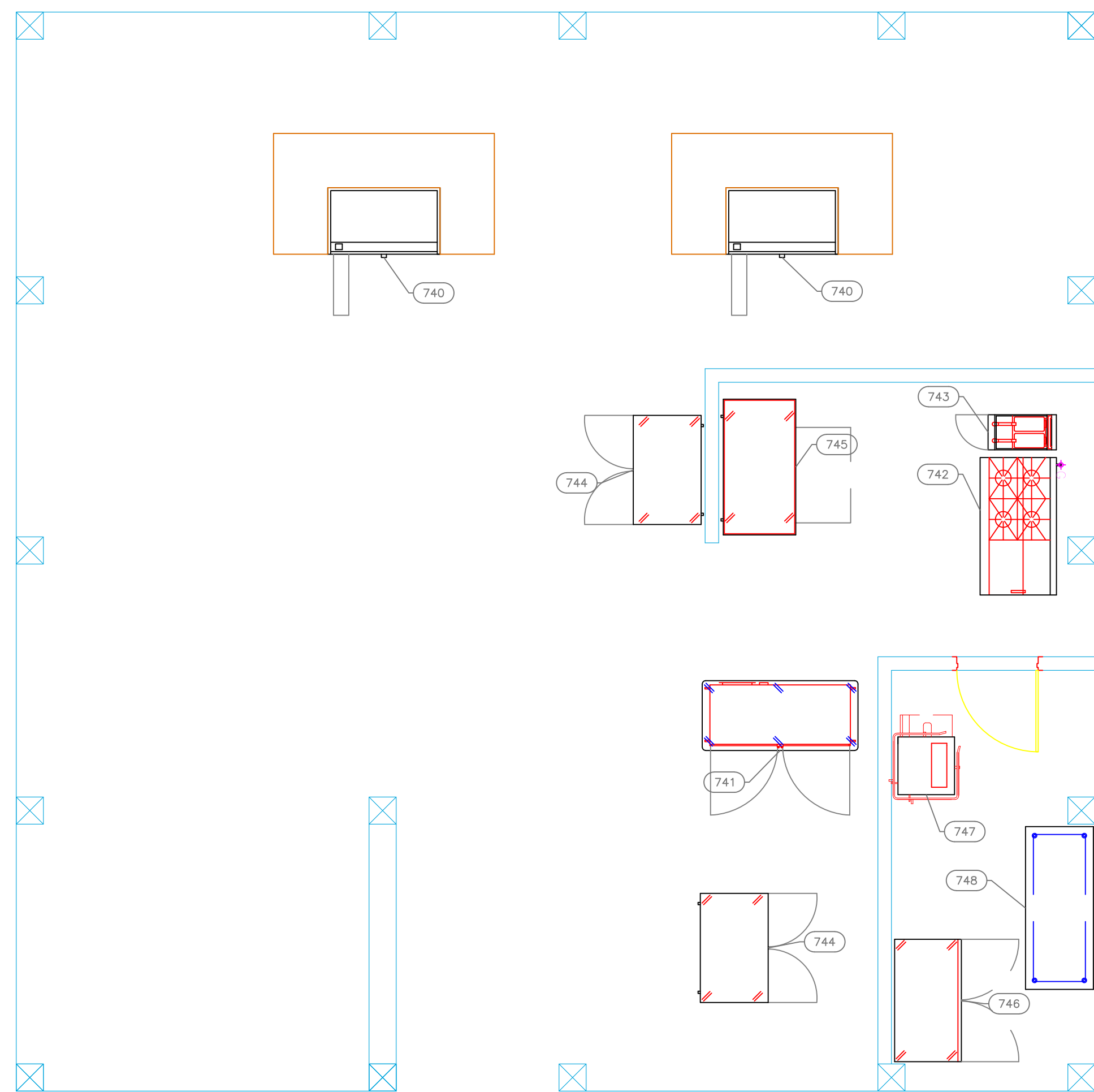

Pier Side

EQUIPMENT SCHEDULE					
ItemNo	Category	Mfr	Model	Quantity	Equipment Remarks
740	Teppanyaki Griddle, Gas	Wolf	TYG48C	2	
741	Heated Banquet Cart	Alto-Shaam	1000-BQ2/192	1	
742	Range, 60", 4 Burners, 24" Griddle	Southbend (Middleby)	4607DD-2G	1	
743	Gas Floor Fryer	Vulcan	1GR45M	1	
744	Undercounter Refrigerator	True Int'l - LATAM/Caribbean (USD)	TUC-48-HC	2	
745	Chef Base	True Int'l - LATAM/Caribbean (USD)	TRCB-52-60-HC	1	
746	Reach-In Refrigerator	True Int'l - LATAM/Caribbean (USD)	T-49-HC	1	
747	Dishwasher, Door Type	CMA Dishmachines	180-C	1	
748	Work Table, Stainless Steel Top	Advance Tabco	MS-306	1	

EQUIPMENT LAYOUT

All Dimensions to be verified on the job site.
 Actual locations for floor drains, and any ventilating equipment to be determined by Engineer.
 Mechanical, Plumbing & Electrical to be checked and verified by Customers MEP Engineer.
 Remote Condensing Units to be located by Architect.
 Exhaust & Supply fans to be located by Architect.

JEWEL GRANDE
 Foodservice
 Montego Bay, Jamaica



INTERNATIONAL INC.
 2055 W 73rd Street, Miami, FL 33016
 Ph: (305)826-8696 Fax: (305)826-9131

1	Preliminary Layout	4-06-26
2		
3		
4		
No.	Revision/Issue	Date

Date
April 06, 2026
 Drawn By
Dayne Gauntlett
 Scale
1/4" = 1'0"

Sheet
FS-1.15

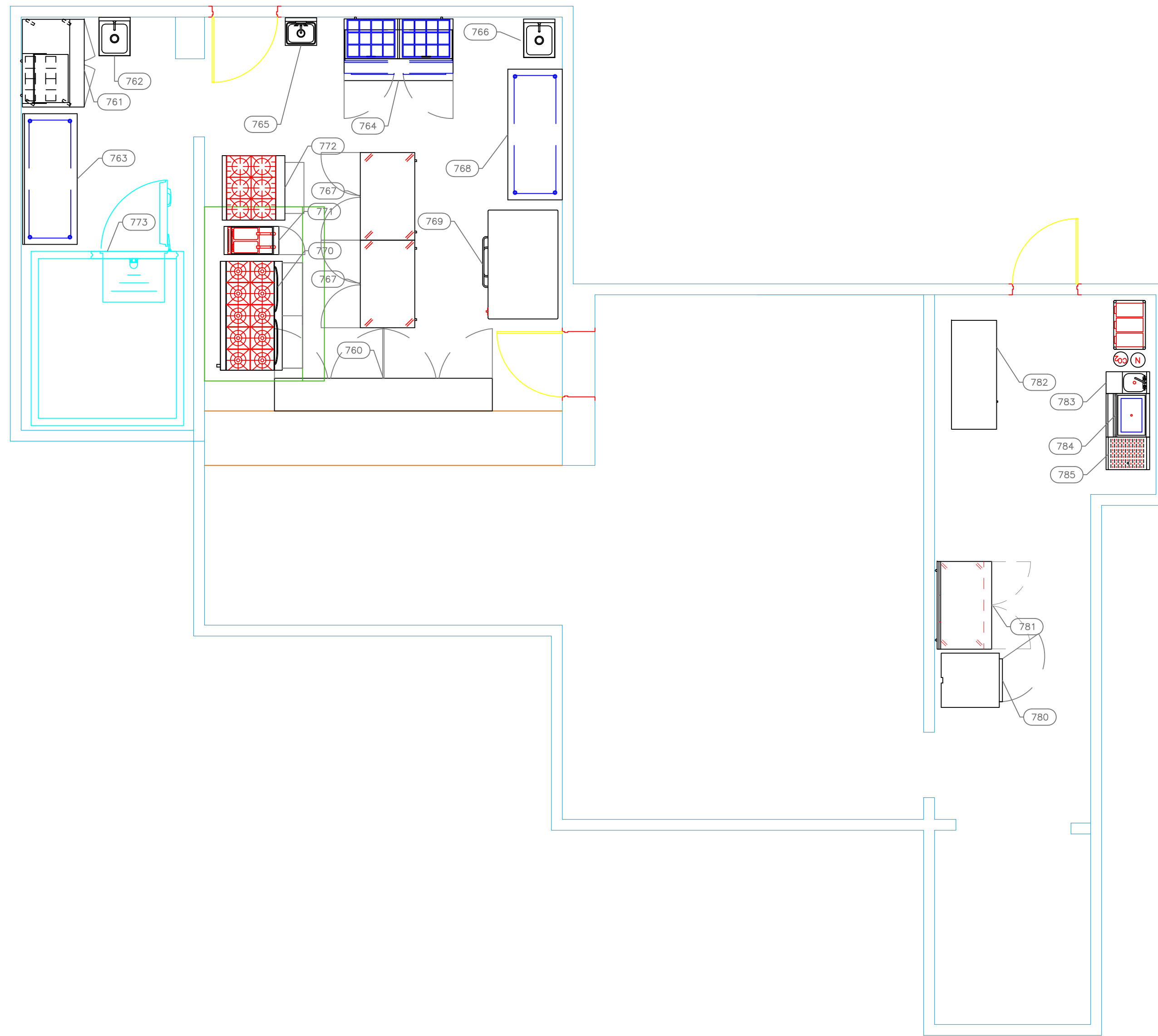

Moon Stone

EQUIPMENT SCHEDULE					
ItemNo	Category	Mfr	Model	Quantity	Equipment Remarks
760	Dish Cabinet	Advance Tabco	DC-1810	1	
761	Mega Top Sandwich / Salad Preparation Refrigerator	True Int'l - LATAM/Caribbean (USD)	TSSU-48-12M-B-HC	1	
762	Hand Sink	Advance Tabco	7-PS-18	1	
763	Work Table, Stainless Steel Top	Advance Tabco	KMS-306	1	
764	Mega Top Sandwich / Salad Preparation Refrigerator	Continental Refrigerator	D60N24M	1	
765	Hand Sink	Advance Tabco	7-PS-66	1	
766	Hand Sink	Advance Tabco	7-PS-18	1	
767	Undercounter Refrigerator	True Int'l - LATAM/Caribbean (USD)	TUC-48-HC	2	
768	Work Table, Stainless Steel Top	Advance Tabco	MS-306	1	
769	Oven, Deck-Type, Gas	Blodgett (Middleby)	961 DOUBLE	1	
770	Range, 60", 10 Open Burners	Southbend (Middleby)	S60DD	1	
771	Gas Floor Fryer	Vulcan	1GR45M	1	
772	Range, 36", 6 Open Burners	Garland Commercial Ranges	U36-6R	1	
773	Walk-in Cooler	Arctic Industries	WALK-IN	1	
773.1	Evaporator for Cooler	Arctic Industries	EVAP C	1	
773.2	Remote Condenser Unit for Cooler	Arctic Industries	COND C	1	
780	Reach-In Refrigerator	Traulsen	G1001-	1	
781	Refrigerated Work Top	True Int'l - LATAM/Caribbean (USD)	TWT-48-HC	1	
782	Back Bar Cabinet, Refrigerated	True Int'l - LATAM/Caribbean (USD)	TBR60-RISZ1L-S-11-1	1	
783	Blender Station	Krowne	KR24-12BD	1	
784	Ice Bin	Krowne	KR19-24-10	1	
785	Drainboard	Krowne	KR24-GS18	1	

EQUIPMENT LAYOUT

All Dimensions to be verified on the job site.
 Actual locations for floor drains, and any ventilating equipment to be determined by Engineer.
 Mechanical, Plumbing & Electrical to be checked and verified by Customers MEP Engineer.
 Remote Condensing Units to be located by Architect.
 Exhaust & Supply fans to be located by Architect.

JEWEL GRANDE
Foodservice
 Montego Bay, Jamaica



INTERNATIONAL INC.

2055 W 73rd Street, Miami, FL 33016
 Ph: (305)826-8696 Fax: (305)826-9131

1	Preliminary Layout	4-06-26
2		
3		
4		
No.	Revision/Issue	Date

Date
April 06, 2026
 Drawn By
Dayne Gauntlett
 Scale
1/4" = 1'0"

Sheet
FS-1.16

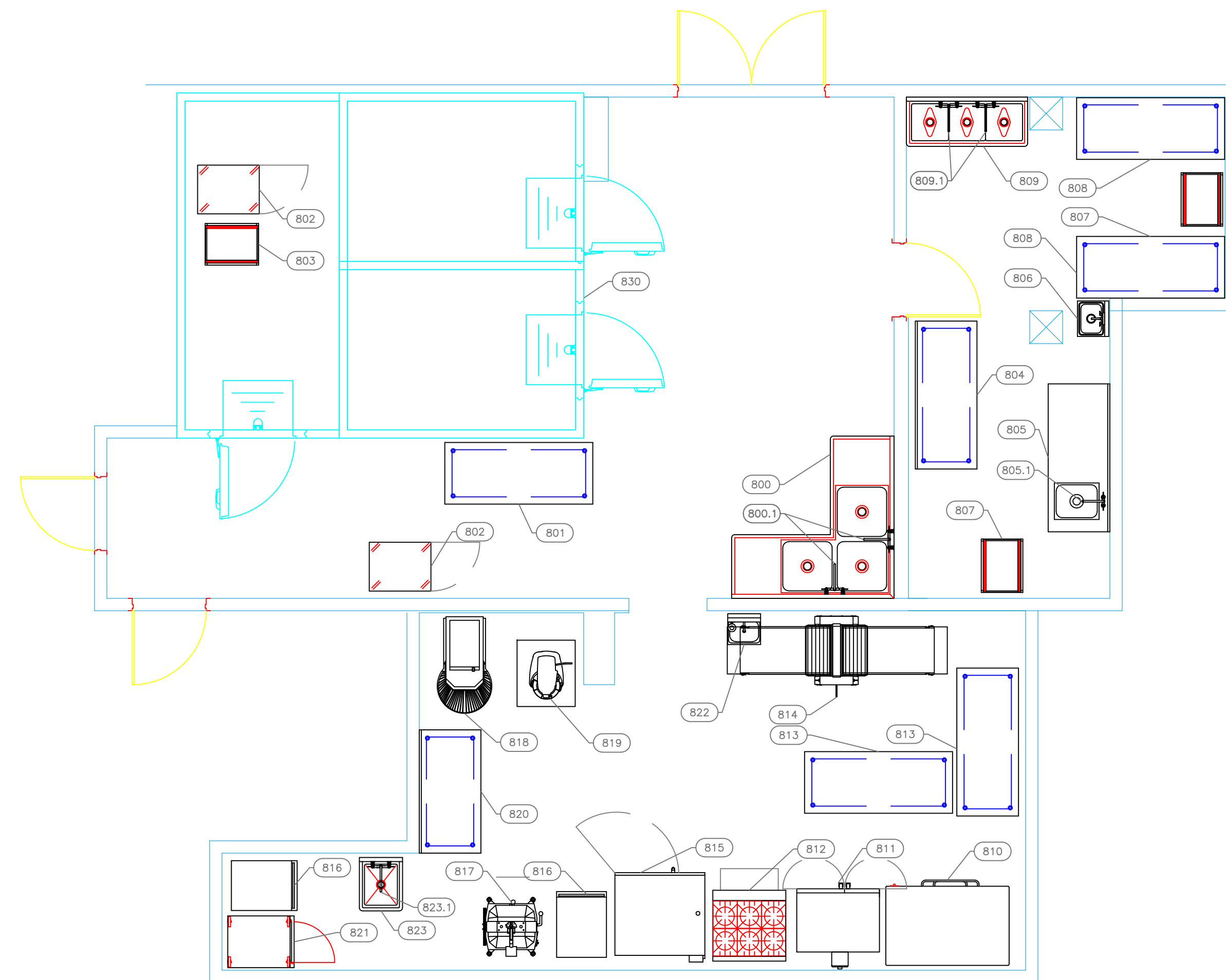

Bakery

EQUIPMENT SCHEDULE					
ItemNo	Category	Mfr	Model	Quantity	Equipment Remarks
800	Corner Sink	Advance Tabco	94-K4-24D	1	
800.1	Wall / Splash Mount Faucet	Krowne	14-812L	1	
801	Work Table, Stainless Steel Top	Advance Tabco	MS-306	1	
802	Cabinet, Enclosed, Bun / Food Pan	Carter-Hoffmann (Middleby)	E8631	2	
803	Bun / Sheet Pan Rack	Advance Tabco	PR20-3K	1	
804	Work Table, Stainless Steel Top	Advance Tabco	KMS-306	1	
805	Work Table, with Prep Sink(s)	Advance Tabco	KMS-11B-306R	1	
805.1	Deck Mount Faucet	Krowne	15-410L	1	
806	Hand Sink	Advance Tabco	7-PS-66	1	
807	Bun / Sheet Pan Rack	Advance Tabco	PR20-3K	2	
808	Work Table, Stainless Steel Top	Advance Tabco	MS-306	2	
809	Three (3) Compartment Sink	Advance Tabco	FC-3-1818	1	
809.1	Wall / Splash Mount Faucet	Krowne	14-812L	1	
810	Oven, Deck-Type, Gas	Blodgett (Middleby)	981-966	1	
811	Convection Oven, Gas	Vulcan	VC4GC	1	
812	Range, 36", 6 Open Burners	Garland Commercial Ranges	U36-6C	1	
813	Work Table, Stainless Steel Top	Advance Tabco	MS-306	2	
814	Dough Sheeter	Doyon (Middleby)	LMA624	1	
815	Combi Oven, Gas	Alto-Shaam	10-20G CLASSIC	1	
816	Proofer Cabinet, Mobile	Cres Cor	121PHUA11D	2	
817	Dough Divider Rounder	Doyon (Middleby)	DSA4354	1	
818	Mixer, Spiral Dough	Doyon (Middleby)	AEF050	1	
819	Planetary Mixer	Hobart	HL200-1	1	
820	Work Table, Stainless Steel Top	Advance Tabco	KMS-305	1	
821	Mobile Heated Cabinet	Metro	CS174HFC-4	1	
822	Hand Sink	Krowne	HS-14	1	
823	One (1) Compartment Sink	Advance Tabco	FC-1-1620	1	
823.1	Wall / Splash Mount Faucet	Krowne	14-812L	1	
830	Walk-in Combo	Arctic Industries	WALK-IN COMBO	1	
830.1	Evaporator for Cooler	Arctic Industries	EVAP C	1	
830.2	Remote Condenser Unit for Cooler	Arctic Industries	COND C	1	
830.3	Evaporator for Freezer	Arctic Industries	EVAP F	1	
830.4	Remote Condenser Unit for Freezer	Arctic Industries	COND F	1	
830.5	Evaporator for Cooler	Arctic Industries	EVAP C	1	
830.6	Remote Condenser Unit for Cooler	Arctic Industries	COND C	1	

EQUIPMENT LAYOUT

All Dimensions to be verified on the job site.
 Actual locations for floor drains, and any ventilating equipment to be determined by Engineer.
 Mechanical, Plumbing & Electrical to be checked and verified by Customers MEP Engineer.
 Remote Condensing Units to be located by Architect.
 Exhaust & Supply fans to be located by Architect.

JEWEL GRANDE
Foodservice
 Montego Bay, Jamaica

INTERNATIONAL INC.
 2055 W 73rd Street, Miami, FL 33016
 Ph: (305)826-8696 Fax: (305)826-9131

1	Preliminary Layout	4-06-26
2		
3		
4		
No.	Revision/Issue	Date

Date
April 06, 2026
 Drawn By
Dayne Gauntlett
 Scale
1/4" = 1'0"

Sheet
FS-1.17

Sentry Dishroom

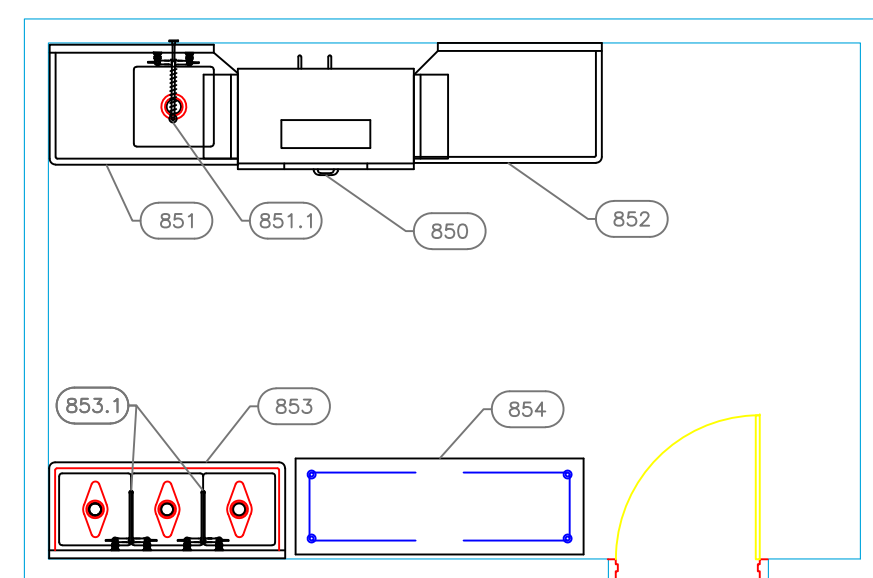

EQUIPMENT SCHEDULE					
ItemNo	Category	Mfr	Model	Quantity	Equipment Remarks
850	Dishwasher, Conveyor Type	CMA Dishmachines	EST-44	1	
851	Soiled Dishtable	Advance Tabco	DTS-S30-48L	1	
851.1	Pre-Rinse Faucet Assembly	Krowne	17-108WL	1	
852	Clean Dishtable	Advance Tabco	DTC-S30-48R	1	
853	Three (3) Compartment Sink	Advance Tabco	FC-3-1818	1	
853.1	Wall / Splash Mount Faucet	Krowne	14-812L	2	
854	Work Table, Stainless Steel Top	Advance Tabco	MS-246	1	

EQUIPMENT LAYOUT

All Dimensions to be verified on the job site.
 Actual locations for floor drains, and any ventilating equipment to be determined by Engineer.
 Mechanical, Plumbing & Electrical to be checked and verified by Customers MEP Engineer.
 Remote Condensing Units to be located by Architect.
 Exhaust & Supply fans to be located by Architect.

JEWEL GRANDE
Foodservice
 Montego Bay, Jamaica



INTERNATIONAL INC.

2055 W 73rd Street, Miami, FL 33016

Ph: (305)826-8696 Fax: (305)826-9131

1	Preliminary Layout	4-06-26
2		
3		
4		
No.	Revision/Issue	Date

Date
April 06, 2026
 Drawn By
Dayne Gauntlett
 Scale
1/4" = 1'0"

Sheet
FS-1.18

Silver Cafe

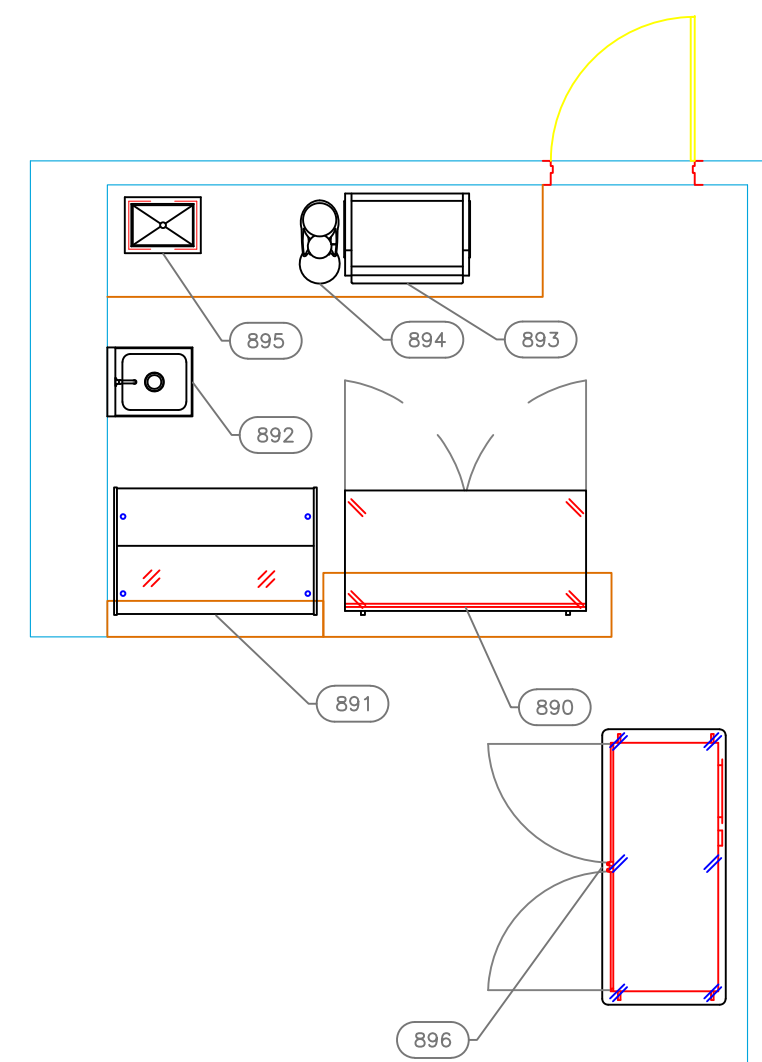

EQUIPMENT SCHEDULE					
ItemNo	Category	Mfr	Model	Quantity	Equipment Remarks
890	Refrigerated Work Top	True Int'l - LATAM/Caribbean (USD)	TWT-60-HC	1	
891	Display Case, Refrigerated Bakery	Infrico USA	IDC-VON12PR	1	
892	Hand Sink	Advance Tabco	7-PS-18	1	
893	Espresso Cappuccino Machine	RositoBeani	TECNICA FS 2 GROUP	1	
894	Coffee Grinder	RositoBeani	F5GM ESPRESSO GRINDER	1	
895	Drop-In Ice Bin	Glastender	DH12	1	
896	Heated Banquet Cart	Alto-Shaam	1000-8Q2/192	1	

EQUIPMENT LAYOUT

All Dimensions to be verified on the job site.
 Actual locations for floor drains, and any ventilating equipment to be determined by Engineer.
 Mechanical, Plumbing & Electrical to be checked and verified by Customers MEP Engineer.
 Remote Condensing Units to be located by Architect.
 Exhaust & Supply fans to be located by Architect.

JEWEL GRANDE
Foodservice
 Montego Bay, Jamaica



INTERNATIONAL INC.
 2055 W 73rd Street, Miami, FL 33016
 Ph: (305)826-8696 Fax: (305)826-9131

1	Preliminary Layout	4-06-26
2		
3		
4		
No.	Revision/Issue	Date

Date
April 06, 2026
 Drawn By
Dayne Gauntlett
 Scale
1/4" = 1'0"

Sheet
FS-1.19

Sentry Pantry

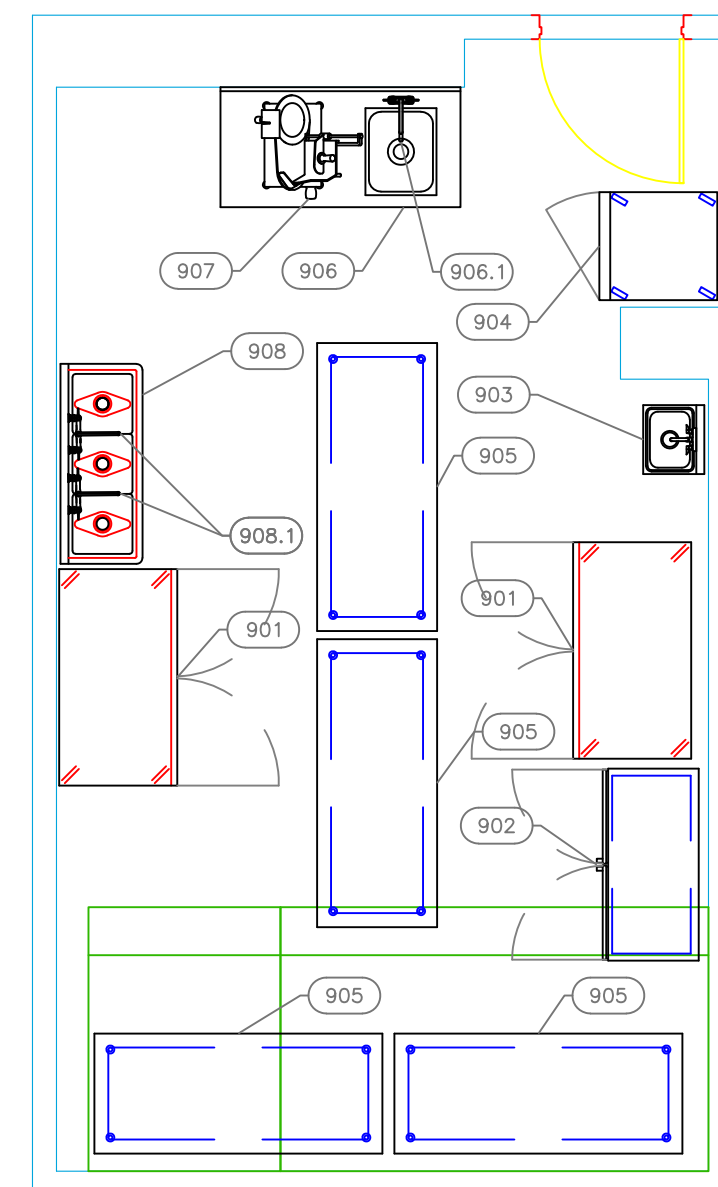

EQUIPMENT SCHEDULE					
ItemNo	Category	Mfr	Model	Quantity	Equipment Remarks
901	Reach-In Refrigerator	True Int'l - LATAM/Caribbean (USD)	T-49-HC	2	
902	Back Bar Cabinet, Non-Refrigerated	Krowne	BD48	1	
903	Hand Sink	Advance Tabco	7-PS-66	1	
904	Reach-In Freezer	True Int'l - LATAM/Caribbean (USD)	T-23F-HC	1	
905	Work Table, Stainless Steel Top	Advance Tabco	MS-306	4	
906	Work Table, with Prep Sink(s)	Advance Tabco	KMS-11B-305R	1	
906.1	Deck Mount Faucet	Krowne	15-410L	1	
907	Food Slicer, Electric	Hobart	EDGE13-11	1	
908	Three (3) Compartment Sink	Advance Tabco	FC-3-1515	1	
908.1	Wall / Splash Mount Faucet	Krowne	14-810L	2	

EQUIPMENT LAYOUT

All Dimensions to be verified on the job site.
 Actual locations for floor drains, and any ventilating equipment to be determined by Engineer.
 Mechanical, Plumbing & Electrical to be checked and verified by Customers MEP Engineer.
 Remote Condensing Units to be located by Architect.
 Exhaust & Supply fans to be located by Architect.

JEWEL GRANDE
Foodservice
 Montego Bay, Jamaica



INTERNATIONAL INC.
 2055 W 73rd Street, Miami, FL 33016
 Ph: (305)826-8696 Fax: (305)826-9131

1	Preliminary Layout	4-06-26
2		
3		
4		
No.	Revision/Issue	Date

Date
April 06, 2026
 Drawn By
Dayne Gauntlett
 Scale
1/4" = 1'0"

Sheet
FS-1.20

Sentry Pantry Storage

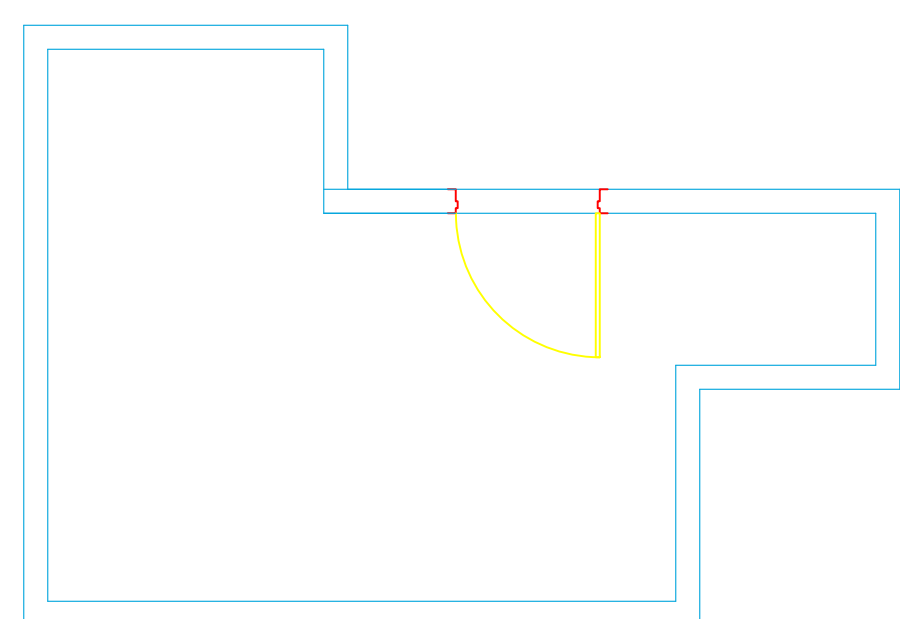

EQUIPMENT LAYOUT

All Dimensions to be verified on the job site.
 Actual locations for floor drains, and any ventilating equipment to be determined by Engineer.
 Mechanical, Plumbing & Electrical to be checked and verified by Customers MEP Engineer.
 Remote Condensing Units to be located by Architect.
 Exhaust & Supply fans to be located by Architect.

1	Preliminary Layout	4-06-26
2		
3		
4		
No.	Revision/Issue	Date

Date
April 06, 2026
 Drawn By
Dayne Gauntlett
 Scale
1/4" = 1'0"

Sheet
FS-1.21

uni-source
 SUPPLY
 INTERNATIONAL INC.
 2055 W 73rd Street, Miami, FL 33016
 Ph: (305)826-8696 Fax: (305)826-9131

JEWEL GRANDE
 Foodservice
 Montego Bay, Jamaica

JEWEL GRANDE
REGISTERED TRADE MARK & S.M.A.

Pavilion Bar

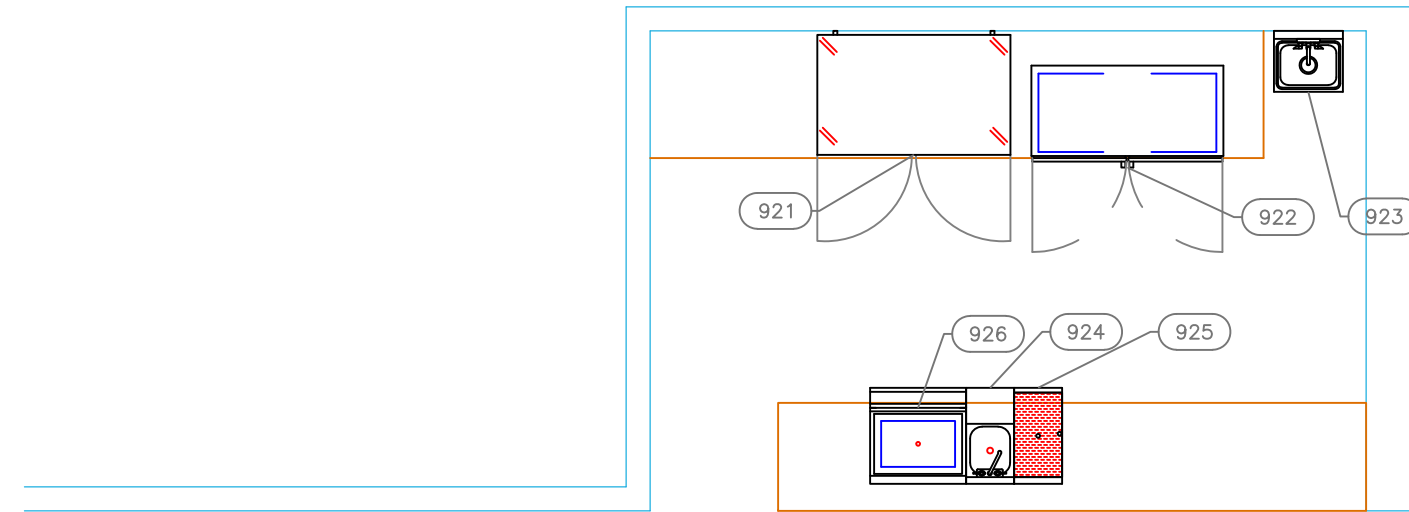

EQUIPMENT SCHEDULE					
ItemNo	Category	Mfr	Model	Quantity	Equipment Remarks
921	Undercounter Refrigerator	True Int'l - LATAM/Caribbean (USD)	TUC-48-HC	1	
922	Back Bar Cabinet, Non-Refrigerated	Krowne	BD48	1	
923	Hand Sink	Advance Tabco	Z-PS-66	1	
924	Blender Station	Krowne	KR24-12BD	1	
925	Drainboard	Krowne	KR24-RG12	1	
926	Ice Bin	Krowne	KR19-24-10	1	

EQUIPMENT LAYOUT

All Dimensions to be verified on the job site.
 Actual locations for floor drains, and any ventilating equipment to be determined by Engineer.
 Mechanical, Plumbing & Electrical to be checked and verified by Customers MEP Engineer.
 Remote Condensing Units to be located by Architect.
 Exhaust & Supply fans to be located by Architect.

JEWEL GRANDE
Foodservice
 Montego Bay, Jamaica



INTERNATIONAL INC.

2055 W 73rd Street, Miami, FL 33016
 Ph: (305)826-8696 Fax: (305)826-9131

1	Preliminary Layout	4-06-26
2		
3		
4		
No.	Revision/Issue	Date

Date
April 06, 2026
 Drawn By
Dayne Gauntlett
 Scale
1/4" = 1'0"

Sheet
FS-1.22

Juice Bar

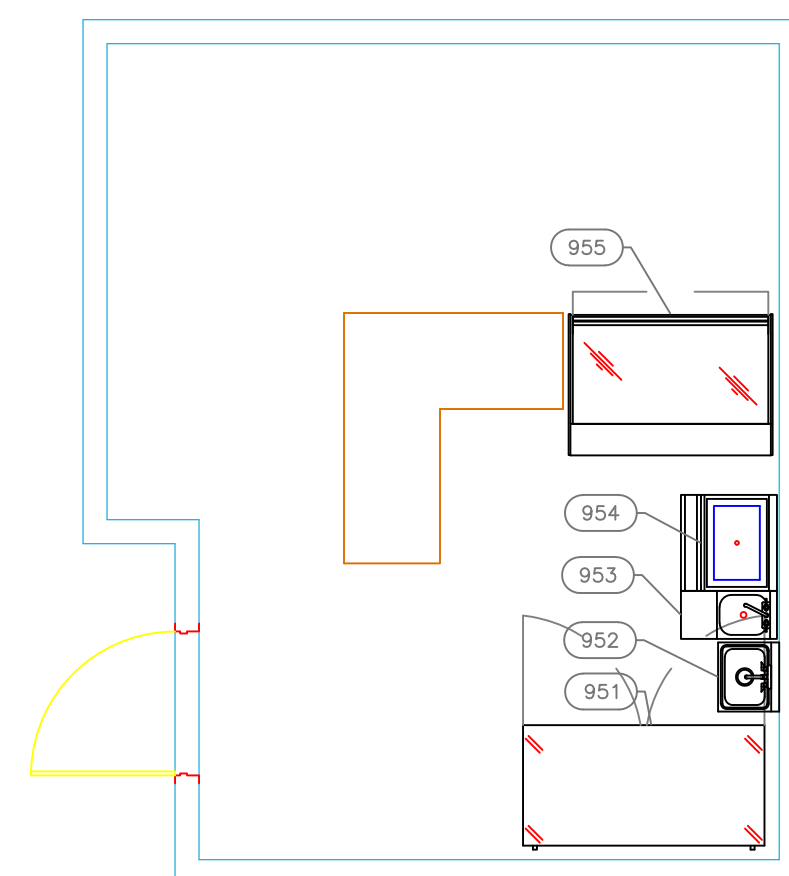

EQUIPMENT SCHEDULE					
ItemNo	Category	Mfr	Model	Quantity	Equipment Remarks
951	Undercounter Refrigerator	True Int'l - LATAM/Caribbean (USD)	TUC-60+HC	1	
952	Hand Sink	Advance Tabco	7-PS-66	1	
953	Blender Station	Krowne	KR24-12BD	1	
954	Ice Bin	Krowne	KR19-24-10	1	
955	Display Case, Refrigerated Bakery	Federal Industries	CGR5042	1	

EQUIPMENT LAYOUT

All Dimensions to be verified on the job site.
 Actual locations for floor drains, and any ventilating equipment to be determined by Engineer.
 Mechanical, Plumbing & Electrical to be checked and verified by Customers MEP Engineer.
 Remote Condensing Units to be located by Architect.
 Exhaust & Supply fans to be located by Architect.

JEWEL GRANDE
Foodservice
 Montego Bay, Jamaica



INTERNATIONAL INC.
 2055 W 73rd Street, Miami, FL 33016
 Ph: (305)826-8696 Fax: (305)826-9131

1	Preliminary Layout	4-06-26
2		
3		
4		
No.	Revision/Issue	Date

Date
April 06, 2026
 Drawn By
Dayne Gauntlett
 Scale
1/4" = 1'0"

Sheet
FS-1.23